



## Chapel Road, TW3

### £549,950

A rare opportunity to acquire this charming Victorian house in a highly sought after and desirable location, comprising of three bedrooms, two reception rooms, separate kitchen and large private rear garden. There is further scope to extend (STPP), making this the perfect purchase for a growing family, investor or developer.

Chapel Road is a sought after and popular residential road conveniently located with Hounslow High Street, Inwood Park, Hounslow Central Station (Piccadilly line) and Hounslow Overground Station within walking distance. There are good local schools in addition to a vast array of amenities nearby.

### Features

- Victorian End of Terrace House
- Three Bedrooms
- Large Rear Garden
- Period Features
- Scope to Extend (STPP)
- Central Location

# Chapel Road, Hounslow, TW3

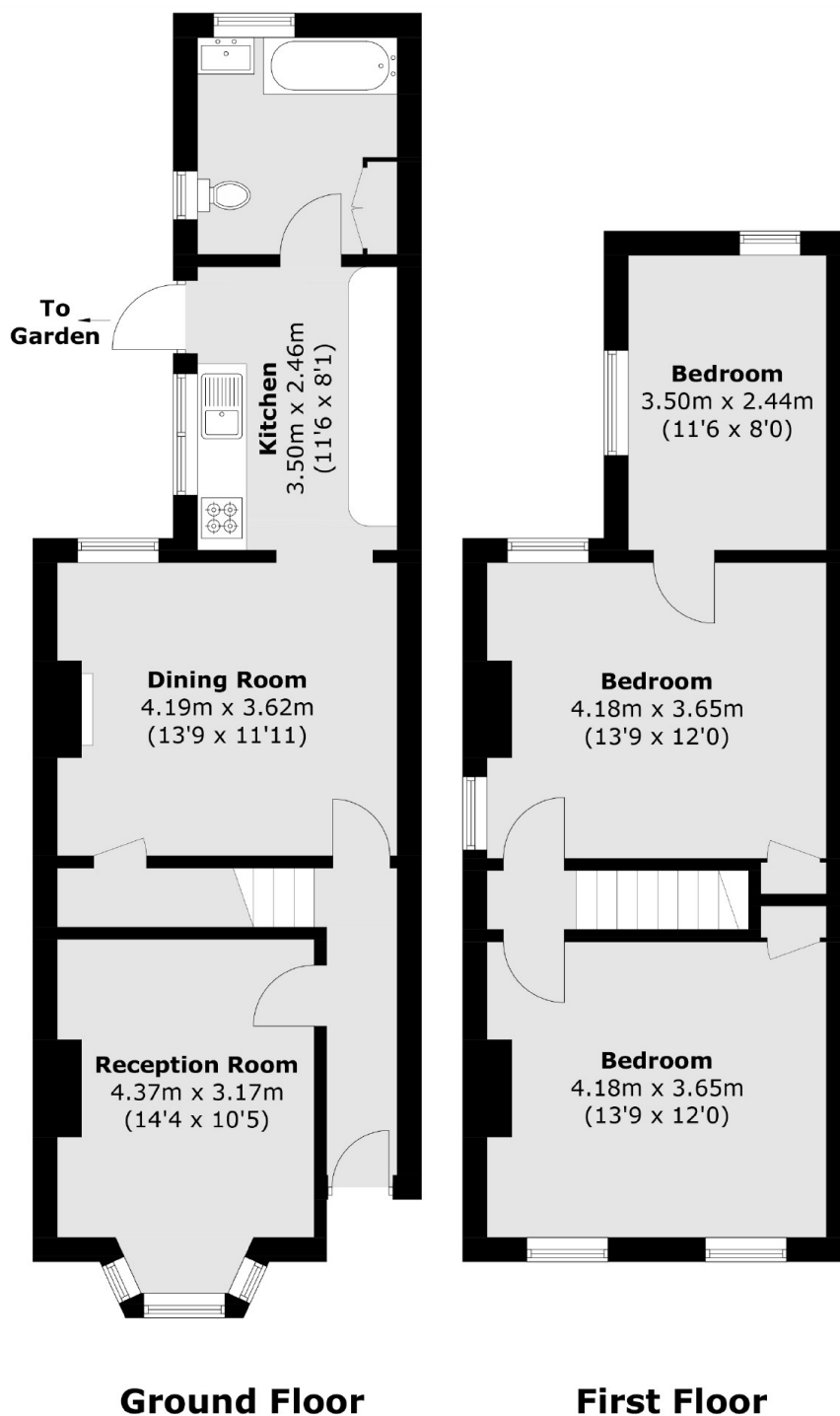

Total area (approx.): 95.4 sq. m (1,026.9 sq. ft)

## Dexters

Isleworth  
568 London Road  
Isleworth  
TW7 4EP  
Sales  
020 8560 1177

Energy Rating: . We aim to make our particulars both accurate and reliable. However they are not guaranteed; nor do they form part of an offer or contract. If you require clarification on any points then please contact us, especially if you're traveling some distance to view. Please note that appliances and heating systems have not been tested and therefore no warranties can be given as to their good working order.

 **RICS** | Regulated  
Estate Agent  
and Letting Agent

dexters.co.uk