



## Pevensey Close, TW7

£585,000

Offered to the market with no onward chain is this delightful corner plot / end of terrace three bedroom freehold property, situated in a quiet residential cul-de-sac within the heart of Osterley. Spanning 1,230 square feet of generous living space, this property benefits from two reception rooms, two bathrooms, a private garage as well as front and rear gardens. There is further scope to extend (STPP)

Superbly situated moments from National Trust's Osterley Park, excellent local schools and Osterley tube station. The property is located close to amenities as well as neighbouring areas of Ealing, Chiswick and Richmond.

### Features

- End Terrace House
- Three Bedrooms
- Two Reception Rooms
- Two Bathrooms
- Private Garage
- Close To Tube Station

# Pevensey Close, Isleworth, TW7

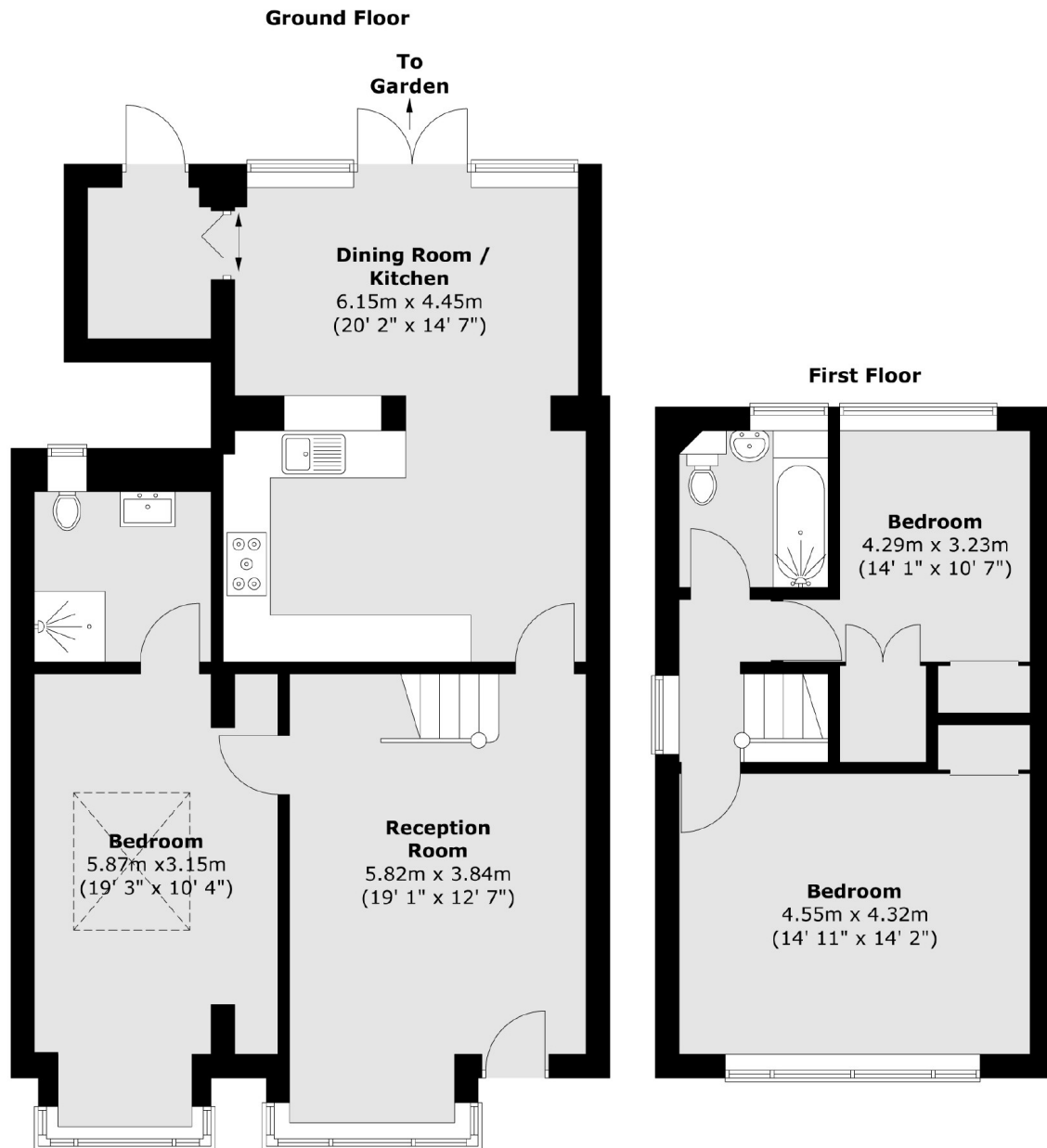

Total area (approx.) : 114.3 sq. m (1230 sq. ft)