



## Woodlands Road, TW7

£359,950

Offered to the market with no onward chain, we are delighted to bring to the market a rare opportunity to acquire this substantial one double bedroom period conversion. Offering over 800 square feet of living space, this unique property is packed full of period features and charm. Further benefits include a share of the freehold, private rear garden and private entrance. Flexible living spaces mean additional rooms can be arranged as an extra reception room, study or guest bedroom.

Woodlands Road is a sought after location in Isleworth and is ideally positioned with easy access to Isleworth Mainline Station with regular train services to London Waterloo. Neighbouring areas of St. Margaret's and Richmond are close by, in addition to a vast array of nearby shops, cafés and restaurants.

### Features

- Share of Freehold
- Period Property and Features
- Private Rear Garden
- Own Entrance
- Sought After Location
- No Chain

# Woodlands Road, Isleworth, TW7

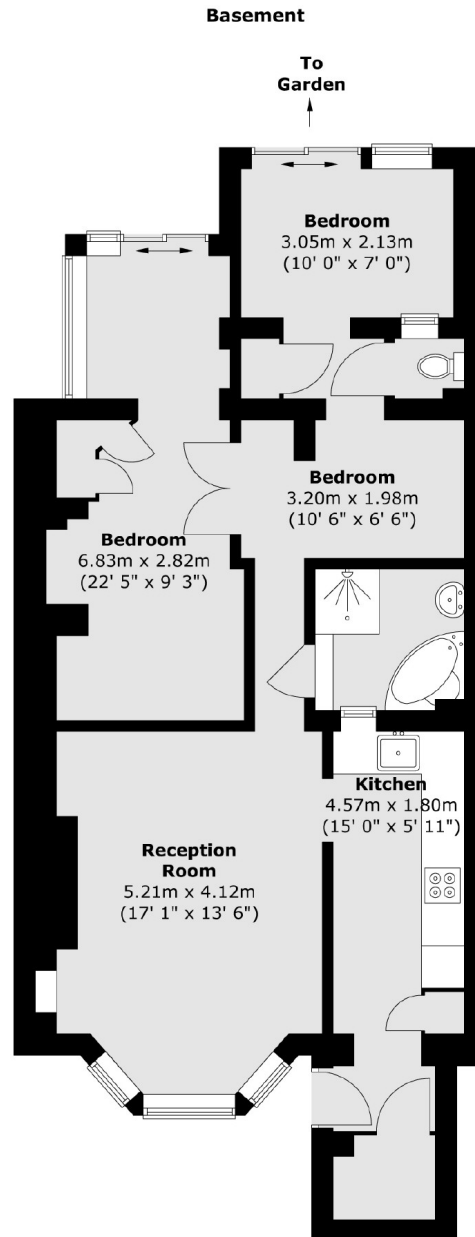

Total area (approx.) : 74.9 sq. m (806 sq. ft)