



## Alderwick Drive, TW3

£525,000

We are delighted to bring to the market this three bedroom terrace house, offering scope to extend (STPP) and modernise throughout, further benefits include an impressive/large garden and off-street parking.

Alderwick Drive is located on a quiet cul-de-sac centrally positioned with easy access to a vast array of shops and restaurants on the nearby High Street. The bus garage, tube and overground railway stations are within walking distance, as well as local schools and parks.

### Features

- Freehold House
- Three Bedrooms
- Driveway
- Scope to Extend (STPP)
- Large Garden
- Central Location

# Alderwick Drive, Hounslow, TW3

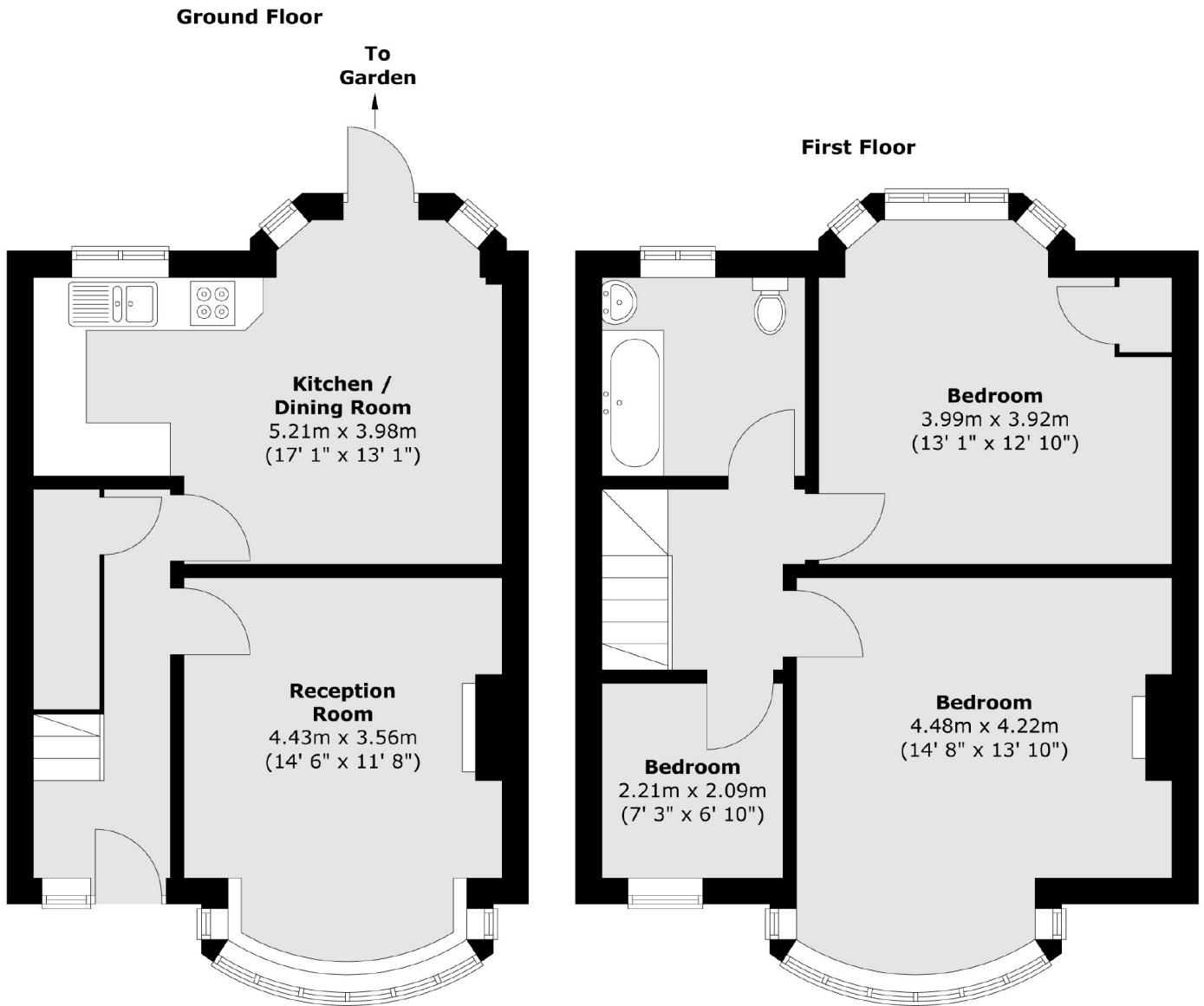

Total area (approx.) : 88.2 sq. m (949 sq. ft)