



Witham Road, TW7

£379,950

A bright and beautiful two bedroom apartment on the top floor of this sought after purpose built development. The property benefits from added loft storage, an allocated parking space within a gated car park, a long lease and communal gardens/bike storage.

Situated on one of Isleworth's premier roads, this property is superbly located close to Isleworth train station and Osterley tube station as well as local parks and amenities.

Features

- Beautifully Presented
- Top Floor Flat
- Two Bedrooms
- Separate Kitchen
- Allocated Parking
- Long Lease

Witham Road, Isleworth, TW7

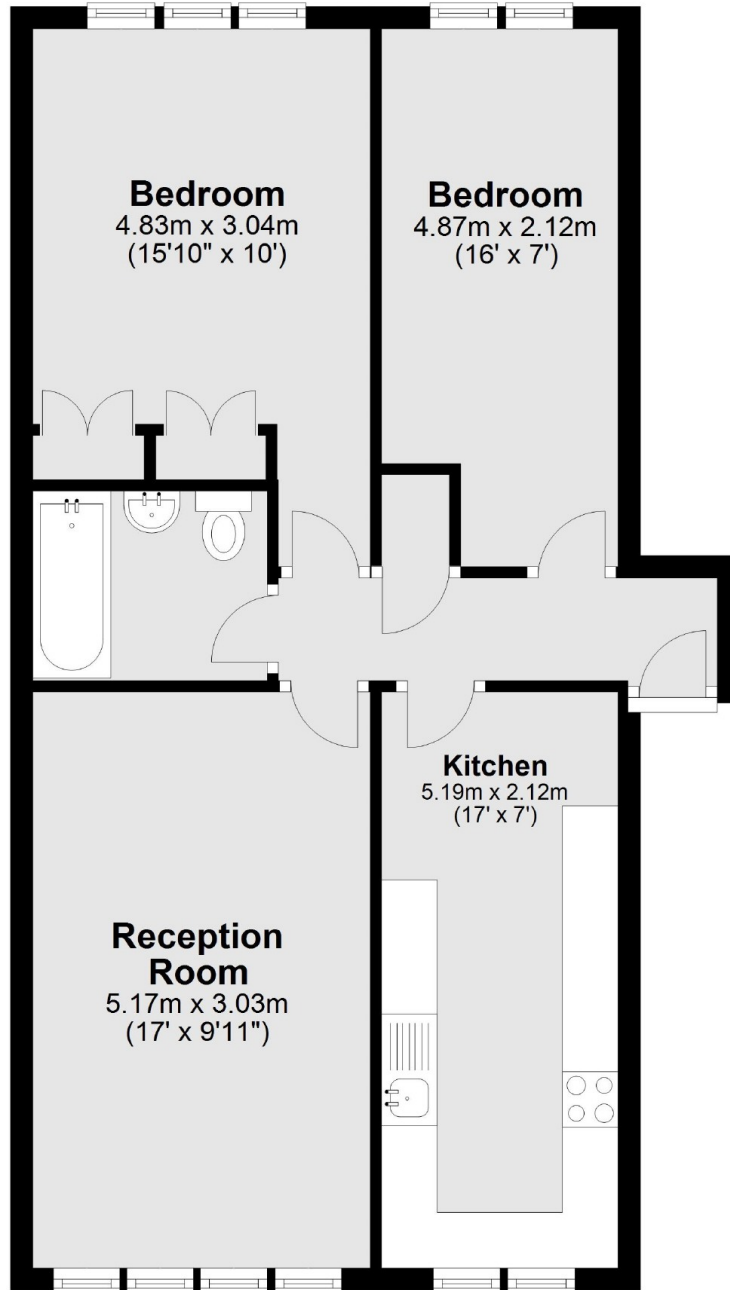

Total area: approx. 59.3 sq. metres (638.2 sq. feet)