



The Grove, TW7

£525,000

Offered to the market with no onward chain, we are delighted to launch this stunning two bedroom apartment offering more than 600sq ft of living space. Further benefits include communal gardens, parking and long lease.

The Grove is a very desirable road in Isleworth offering immediate access to the High Street and Isleworth and Osterley Stations. Mainline and tube services access in to Waterloo, Hammersmith, Earls Court and Kings Cross.

Features

- Two Double Bedrooms
- Second Floor Apartment
- Long Lease
- Communal Gardens
- Desirable Location
- No Chain

The Grove, Isleworth, TW7

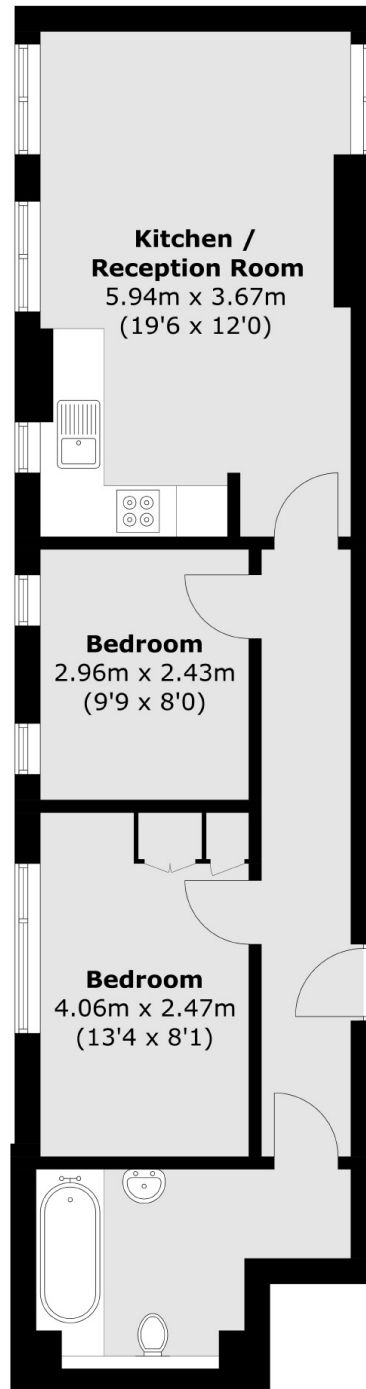

Total area (approx.): 56.1 sq. m (603.9 sq. ft)