



James Street, TW3

£550,000

A beautifully presented three bedroom family house located on a quiet residential road. The property benefits from a full refurbishment throughout, a large rear garden, potential to extend and no onward chain.

James Street is a residential area situated close to Hounslow East station (Piccadilly line), Hounslow High Street and local parks. The property is also situated to nearby areas of Isleworth, Twickenham and St Margarets.

Features

- Three Bedrooms
- Mid Terrace
- Recently Refurbished
- Large Garden
- No Onward Chain
- Potential To Extend (STPP)

James Street, Hounslow, TW3

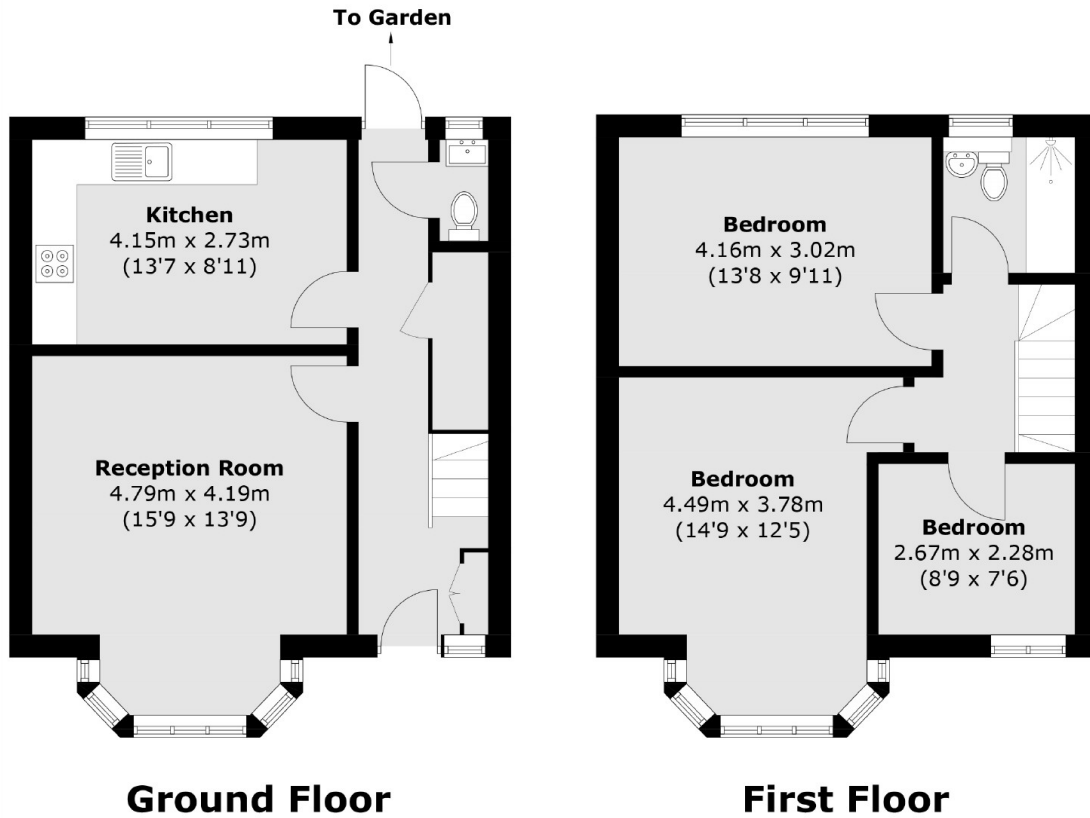

Total area (approx.): 85.3 sq. m (918.1 sq. ft)