



Whitton Road, TW3

£274,950

We are delighted to bring to the market this beautifully presented first floor apartment with own entrance. Benefits include large double bedroom, new kitchen and bathroom, in addition to off-street parking/driveway.

Superbly positioned between Whitton and Hounslow Mainline station, parks and schools. Whitton and Hounslow high street are within a short walking distance from a vast array of shops and restaurants.

Features

Top Floor A partment
Immaculately Presented
New Bathroom & Kitchen

Own Entrance
Close to Train Stations

Whitton Road, Hounslow, TW3

First Floor

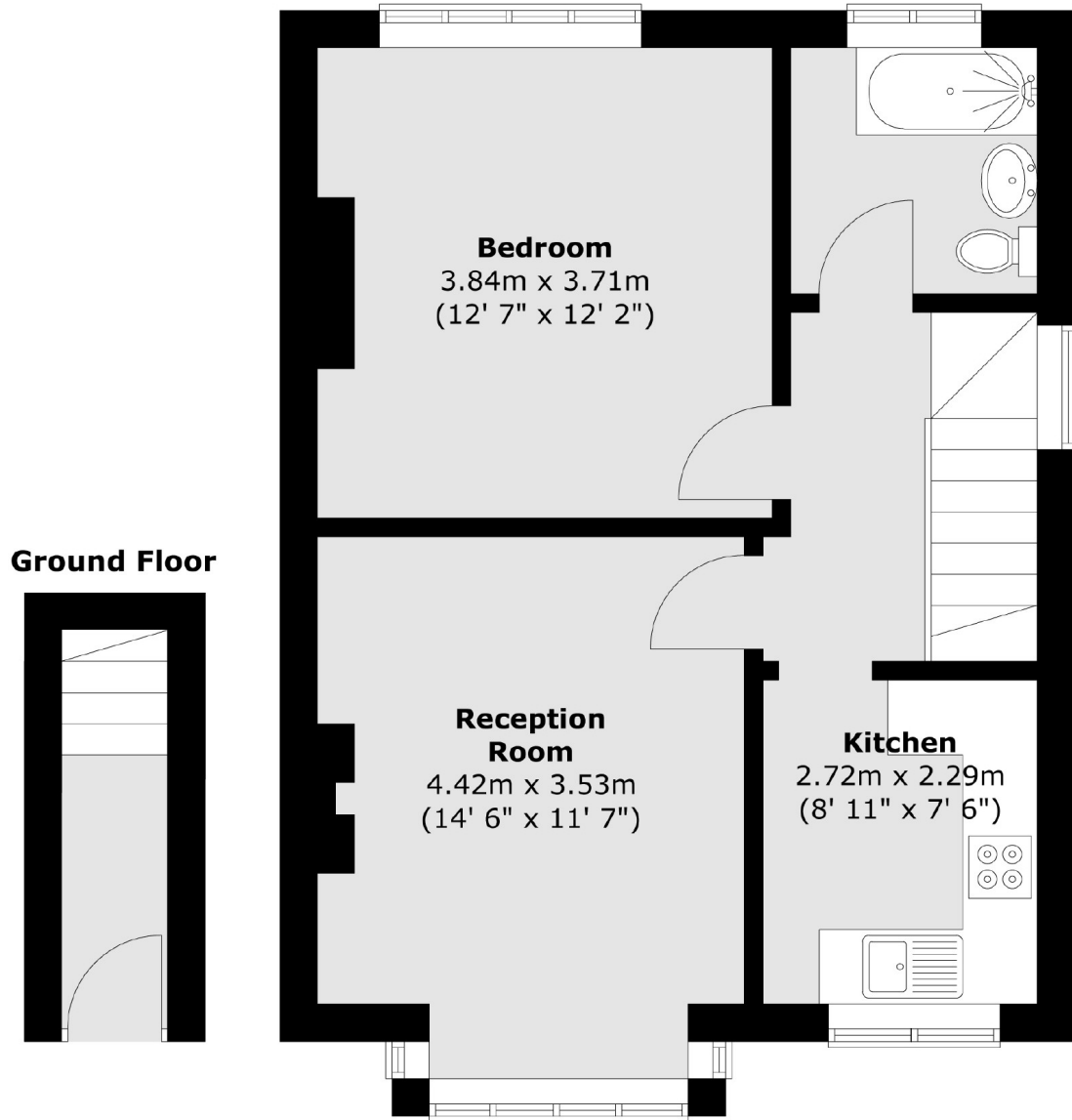

Total area (approx.) : 49.7 sq. m (535 sq. ft)