



Spring Grove Crescent, TW3

£850,000

We are pleased to launch this exceptional four bedroom semi detached house. The property comprises of a large through lounge, utility room, two bathrooms and a rear outbuilding, as well as benefitting from side access to a beautifully landscaped rear garden.

Superbly situated within walking distance to both Osterley and Hounslow East stations, local amenities and parks. The property is close to excellent schools and also has easy access to the A4/M4 in and out of London.

Features

- Four Bedrooms
- Two Bathrooms
- Semi Detached
- Off Street Parking
- Rear Outbuilding
- Potential to Extend (STPP)

Spring Grove Crescent, Hounslow, TW3

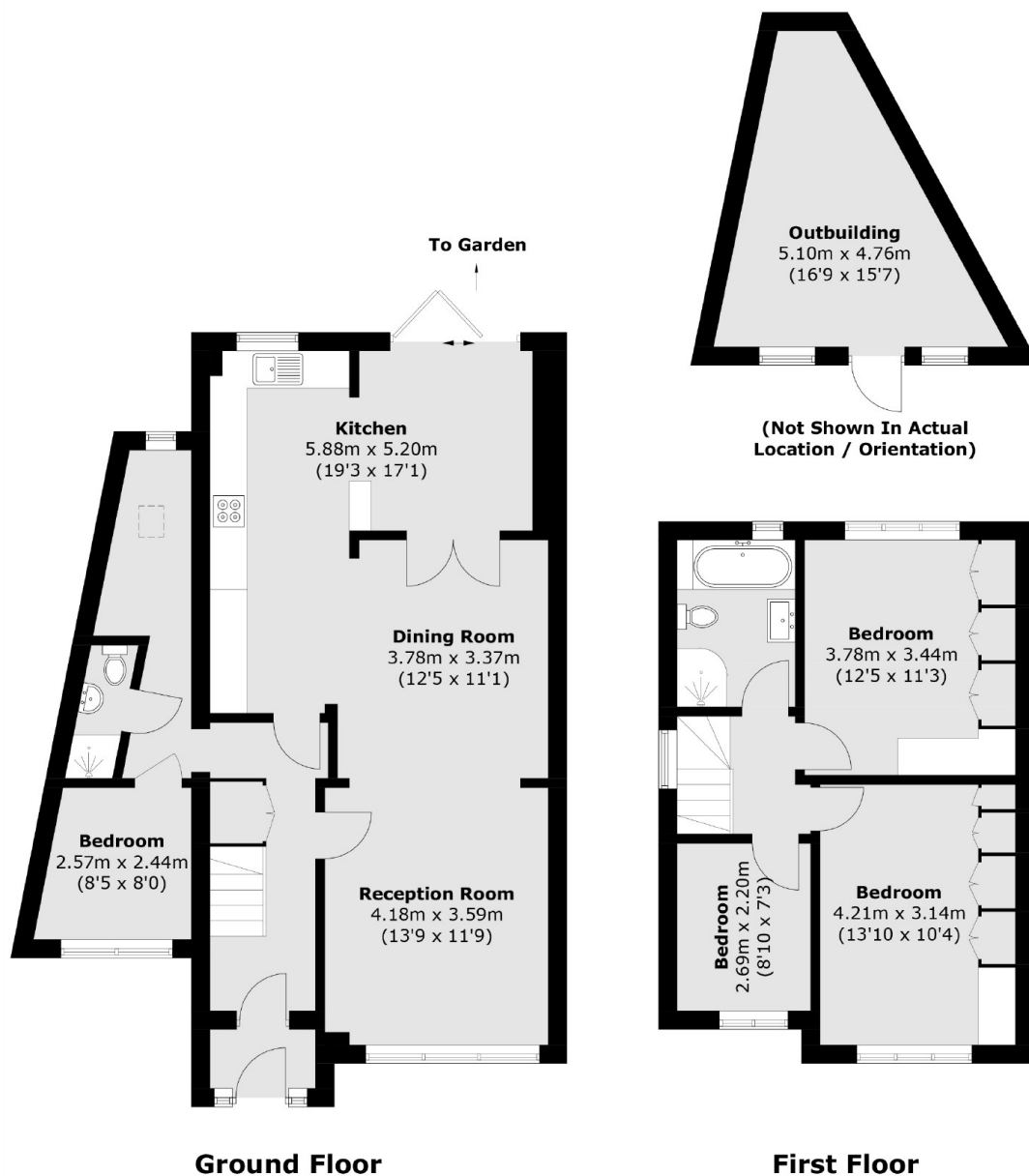

Total area (approx.) : 121.4 sq. m (1,306.7 sq. ft)
Outbuilding : 14.7 sq. m (158.2 sq. ft)