



Northumberland Gardens, TW7

£425,000

Offered to the market with no onward chain, is this beautifully presented and newly renovated two double bedroom ground floor maisonette. Benefits include large front garden, private rear patio, newly fitted kitchen/bathroom and WC, in addition to a long lease.

Northumberland Gardens is within walking distance to Syon Lane train station and just one mile to Isleworth main line station.

Features

- Two Double Bedrooms
- Large Reception Room
- Fully Renovated Throughout
- Front Garden
- Rear Patio
- Long Lease - 953 Years
- No Chain

Northumberland Gardens, Isleworth, TW7

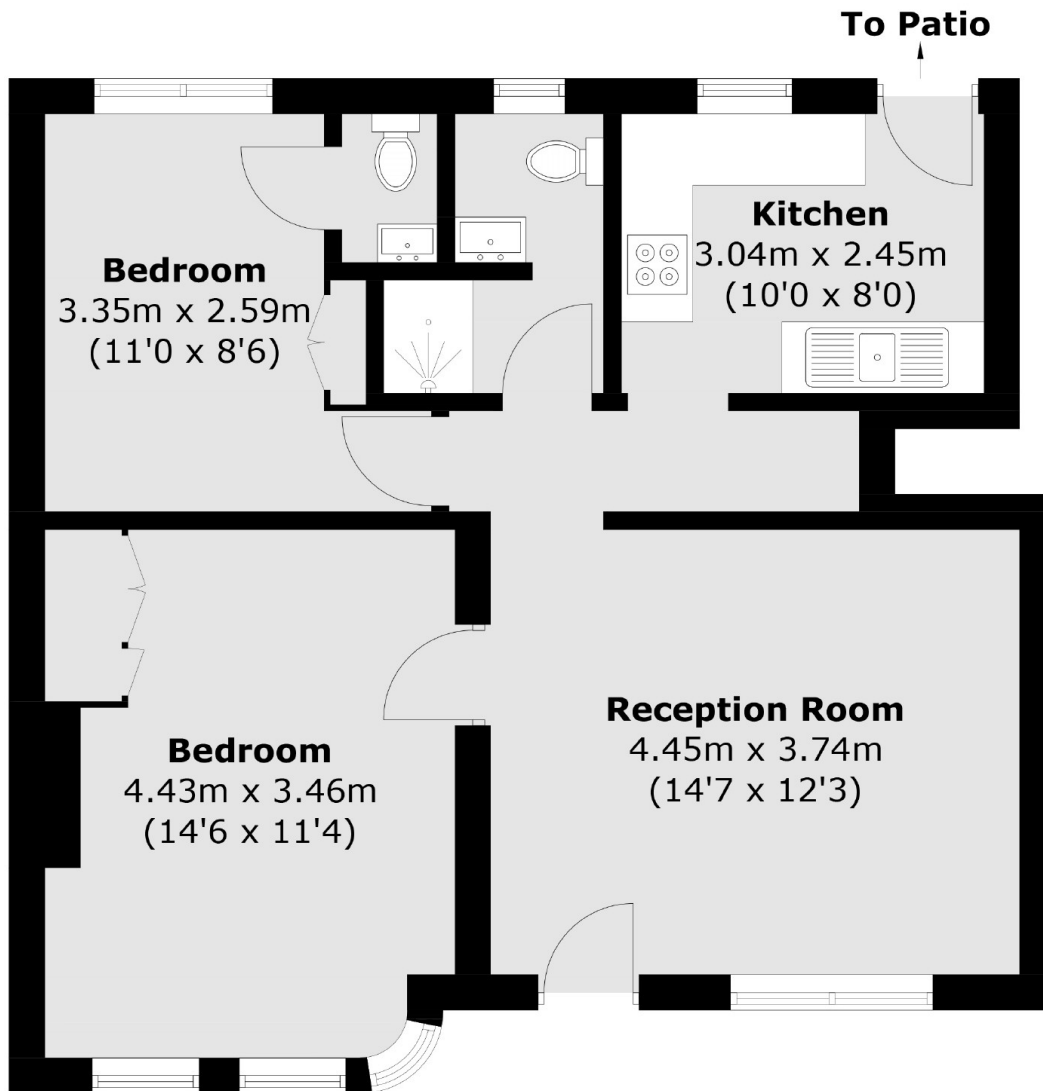

Total area (approx.): 59.5 sq. m (640.4 sq. ft)