



## Garrison Close, TW4

£465,000

We are pleased to present a newly refurbished two bedroom property located on a quiet residential cul-de-sac offering no onward chain. The property benefits from an allocated parking space, a rear outbuilding and a conservatory leading onto a lovely private garden.

Primely situated moments away from outstanding local schools, amenities and parks. There is easy access to Whitton and Isleworth, as well as the M4 providing access in and out of Central London.

### Features

- Two Bedrooms
- Freehold
- Quiet Residential Area
- Allocated Parking
- Newly Refurbished
- Front and Rear Garden

# Garrison Close, Hounslow, TW4

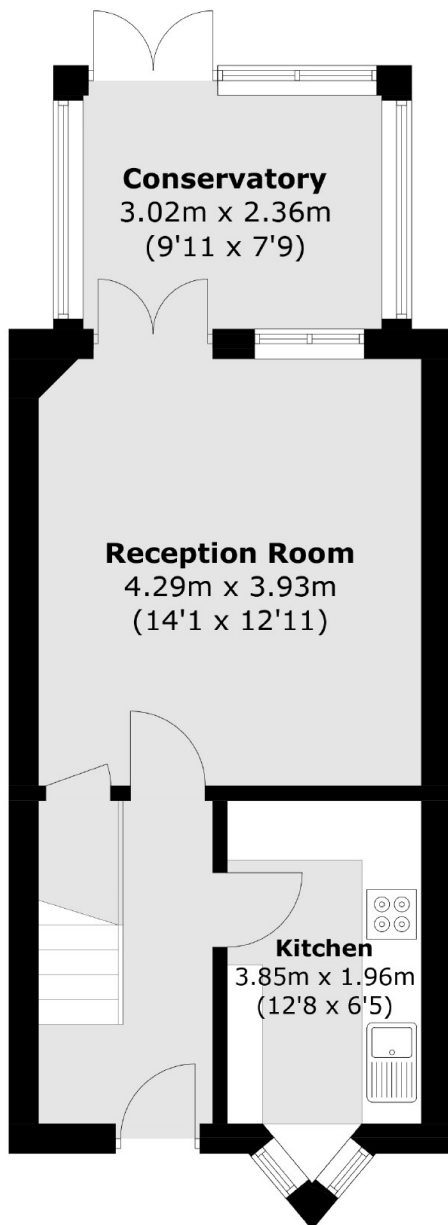

**Ground Floor**

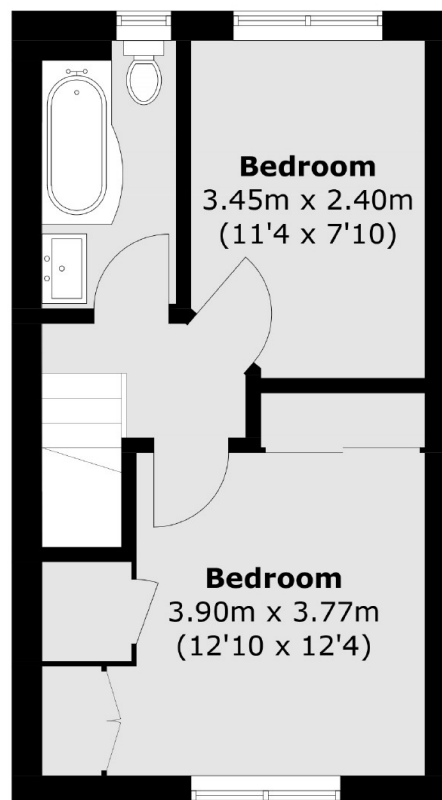

**First Floor**

Total area (approx.): 66.4 sq. m (714.6 sq. ft)