



## Ridgeway Road, TW7

£799,950

We are delighted to launch this three bedroom detached bungalow. This is a rare opportunity to purchase a house with scope to update, modernise and extend (STPP) and is positioned on a large plot of land. Benefits include a large front and rear garden, double garage, driveway and is offered to the market with no chain (awaiting grant of probate).

Ridgeway Road is ideally placed for access to Isleworth station, Osterley tube station (Piccadilly Line) and all the local shops all on the door step

### Features

- Detached / Double Fronted
- Large Plot
- Double Garage
- Scope to Extend & Modernise
- Sought After Road
- No Chain

# Ridgeway Road, Isleworth, TW7

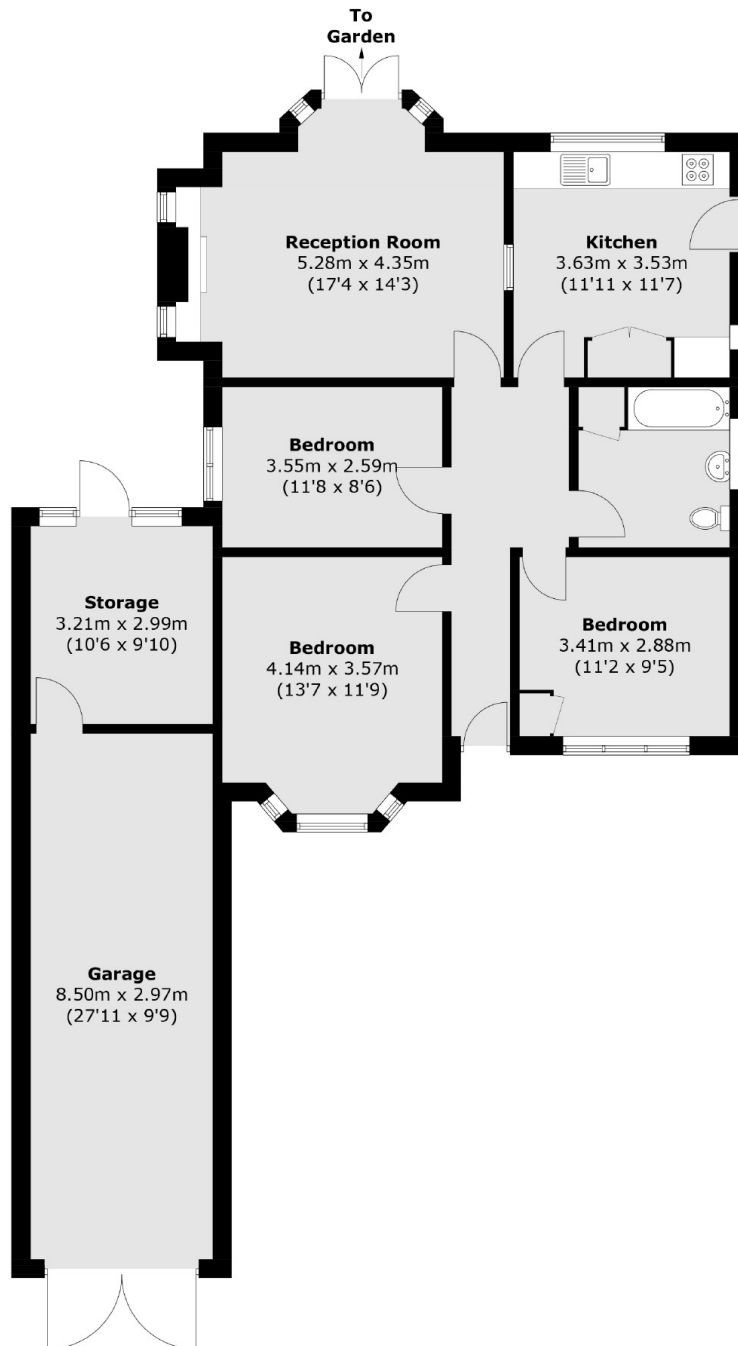

Total area (approx.): 84.7 sq. m (911.7 sq. ft)  
Garage & Storage (approx.): 35.5 sq. m (382.1 sq. ft)