



Munster Avenue, TW4

£550,000

A fantastic opportunity to acquire a three bedroom semi detached family home, situated on a sought after residential road. The property is unmodernised and ideal for those looking to add their own stamp, with further benefits including two reception rooms, large rear garden, no onward chain and ample opportunity to extend (STPP).

Ideally close to excellent local schools, shops and parks. There is easy access to local transport links including both Hounslow West tube and Hounslow train stations, as well as neighbouring areas of Whitton, Twickenham and Isleworth.

Features

- Semi Detached
- Three Bedrooms
- Two Reception Rooms
- Large Garden
- Potential To Extend (STPP)
- No Onward Chain

Munster Avenue, Hounslow, TW4

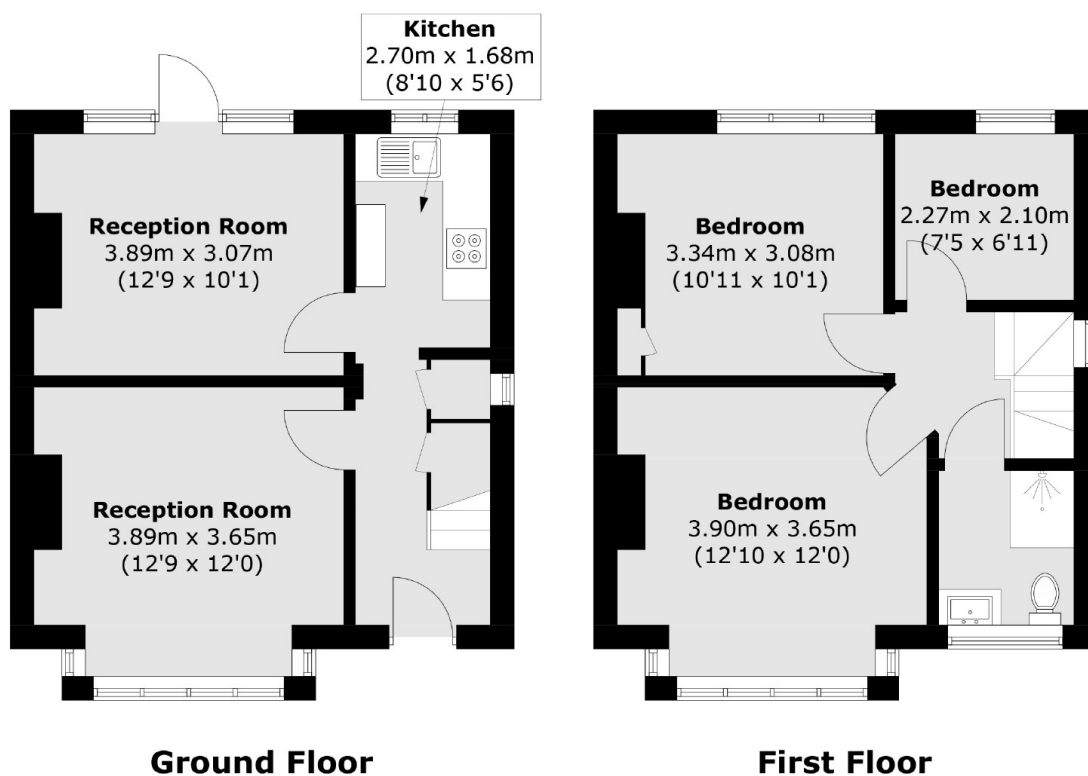

Total area (approx.): 74.9 sq. m (806.2 sq. ft)