



## Draper Close, TW7

£230,000

A beautiful two double bedroom apartment within a gated retirement development. The property is specifically for over 60's and has been refurbished throughout with benefits including spacious rooms, residents parking, lift service and communal gardens. Offered to the market with no onward chain.

The property is superbly situated close to shops and parks as well as local transport links including bus stops and train stations. There is easy access to local areas of Richmond, Twickenham and Chiswick.

### Features

- Over 60's Only
- Beautifully Presented
- Gated Development
- Two Bedrooms
- Residents Parking
- No Onward Chain

# Draper Close, Isleworth, TW7

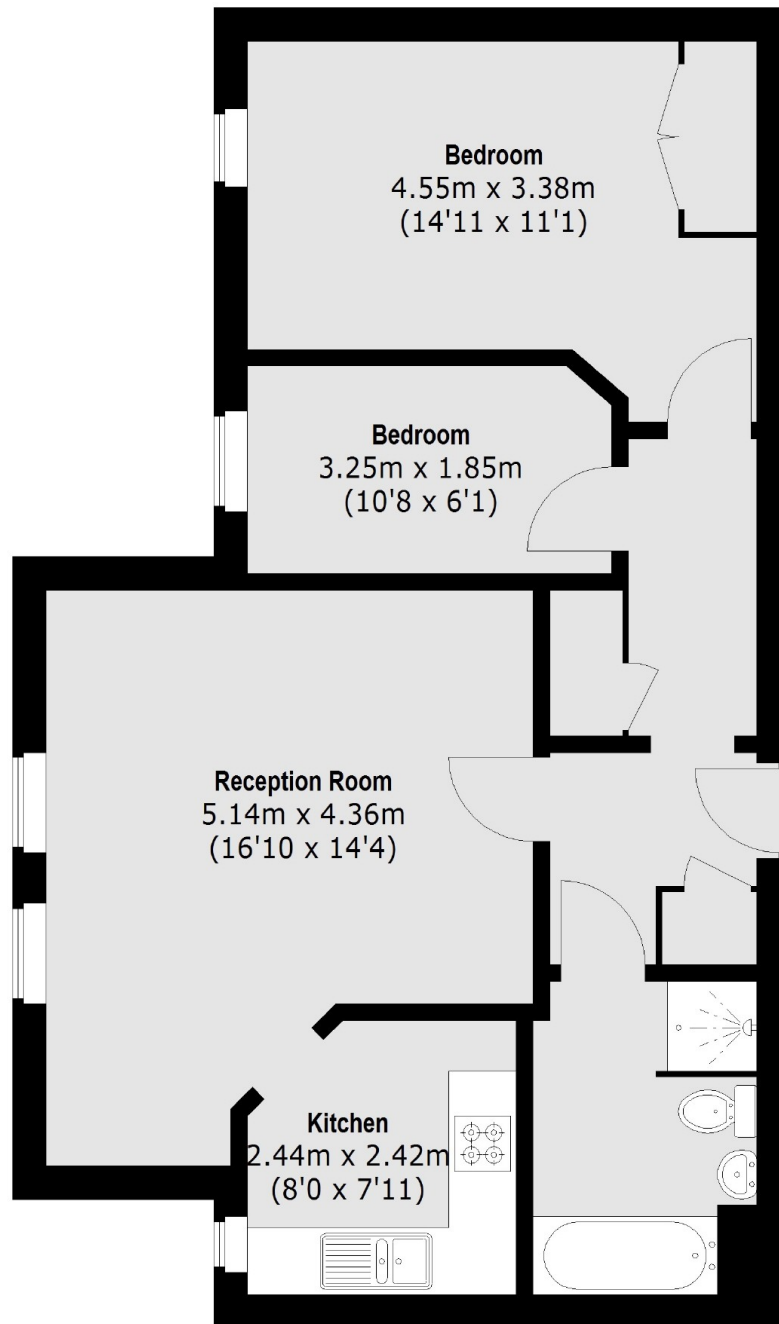

Total area (approx.):60.40 sq. m (650 Sq. ft)