

SNELLERS

ESTATE AGENTS



Hampton Lane, TW13

£1,900 PCM

A beautifully presented two bedroom end of terrace house in Hampton, finished to a modern standard throughout. The property has two double bedrooms, two bathrooms and a large home office in the garden.



Hampton Lane is located on the borders of Hampton/Hanworth with transport links to Kingston and easy access to A316/M3.

- Home Office • Two Double Bedrooms • Two Bathrooms •
- Excellent Condition • Pretty Garden • Double Reception Room •



SNELLERS

ESTATE AGENTS

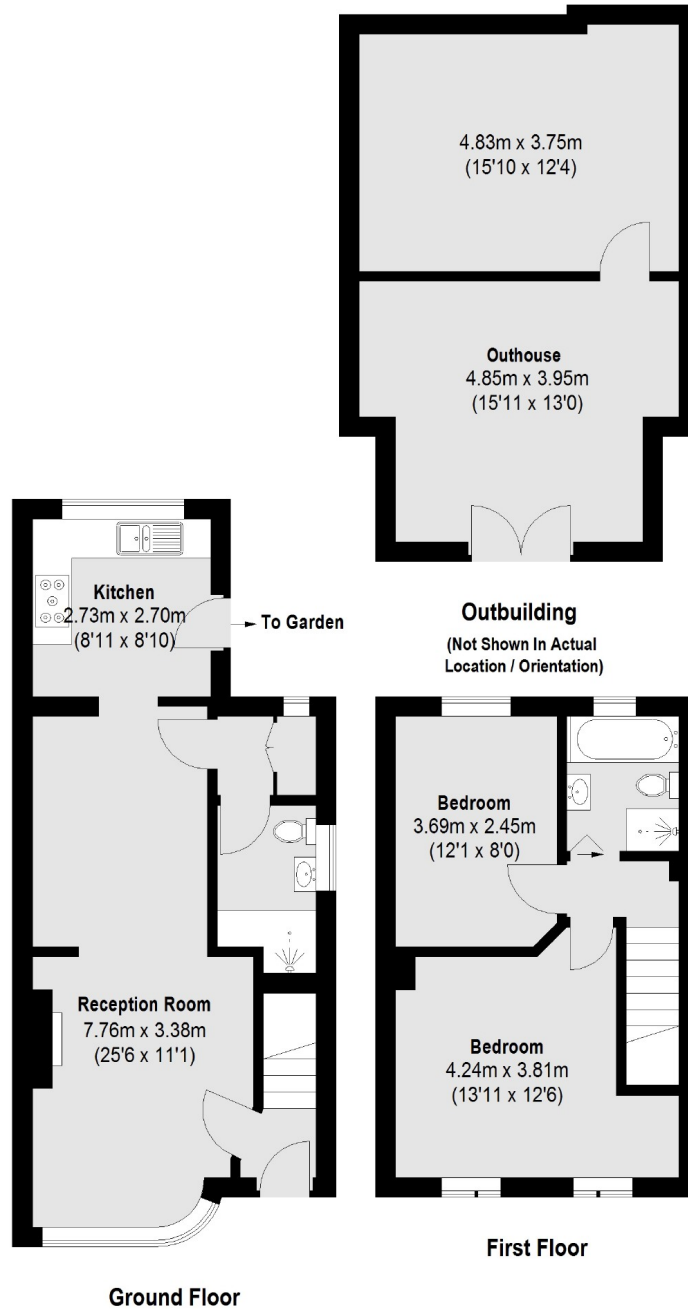

Total area (approx.): 70.48 sq. m (759 sq. ft)
Outbuilding: 35.78 sq. m (385 sq. ft)

Snellers Hampton Hill Lettings
197-201 High Street
Hampton Hill
TW12 1NL
020 8783 3633
hamptonlettings@snellers.co.uk

Energy Rating: D We aim to make our particulars both accurate and reliable. However they are not guaranteed; nor do they form part of an offer or contract. If you require clarification on any points then please contact us, especially if you're traveling some distance to view. Please note that appliances and heating systems have not been tested and therefore no warranties can be given as to their good working order