

SNELLERS

ESTATE AGENTS



Queens Reach, KT8

£725,000

Set within this highly sought after gated development and offered to the market with no onward chain is this well presented two bedroom two bathroom ground floor apartment including allocated parking enviably located in the heart of Hampton Court.



The accommodation offers a welcoming entrance hallway, a kitchen, a large bay fronted reception room with a fireplace, a family bathroom, a principle bedroom with an en suite bathroom and a second double bedroom.

Further benefits include well kept riverside communal gardens.

Queens Reach is moment aways from Hampton Court village, the railway station, the River Thames and the historic Hampton Court Palace.

- Ground Floor • Two Bedrooms • Two Bathrooms •
- Over 1000 sq.ft • Allocated Parking • No Chain •



SNELLERS

ESTATE AGENTS

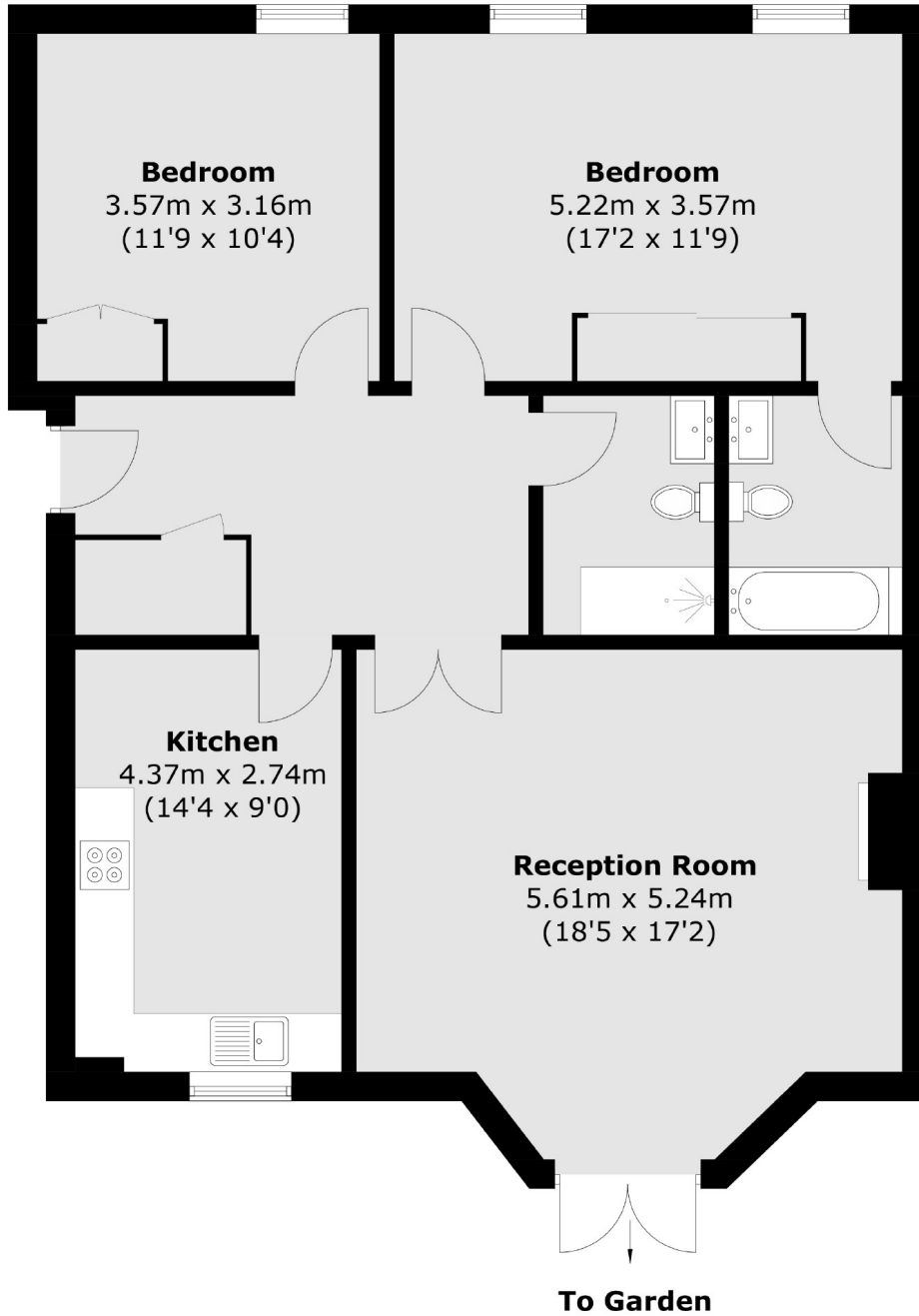

Total area (approx.): 94.0 sq. m (1020.4 sq. ft)

Snellers Hampton Hill Sales
197-201 High Street
Hampton Hill
TW12 1NL
020 8783 0083
hamptonsales@snellers.co.uk

Energy Rating: C We aim to make our particulars both accurate and reliable. However they are not guaranteed; nor do they form part of an offer or contract. If you require clarification on any points then please contact us, especially if you're traveling some distance to view. Please note that appliances and heating systems have not been tested and therefore no warranties can be given as to their good working order