

SNELLERS

ESTATE AGENTS



Hatherop Road, TW12

£850,000

Backing directly onto Hatherop Park with panoramic views to the rear is this end of terraced 1920's family home offering 1,105 sq ft of accommodation over two floors. The property offers the scope, s.t.p.p., to extend to the rear and into the loft space to create a spectacular family home.



The ground floor accommodation consists of an entrance porch leading to an entrance hall with storage cupboards and a staircase leading to the first floor landing, a bay fronted reception room with a feature fireplace with built-in display shelving to either recess, a second reception room with a built-in storage cupboard and an additional built-in storage cupboard with display shelving above, a third reception room with uPVC double glazed sliding doors leading to the rear garden and a separate fitted kitchen. The first floor accommodation consists of a landing, a bay fronted double bedroom with a built-in wardrobe and storage cupboard with display shelving above, a second double bedroom with built-in wardrobes with central display shelving and a vanity wash hand basin, a single bedroom, a modern family shower room and a separate wc. Outside to the front is a small garden with shrub displays. To the rear is a large west facing garden which is mostly laid to lawn with established flower and shrub borders and displays, rest laid to patio, a door provides access to a detached double garage with vehicular access to the side.

Hatherop Road is ideally located for the recreational facilities of Hatherop Park and the wider amenities of Hampton Village including Hampton train station and an array of boutique shops, cafes and a Waitrose food store. There are many well regarded schools locally in both the state and private sectors.



SNELLERS

ESTATE AGENTS

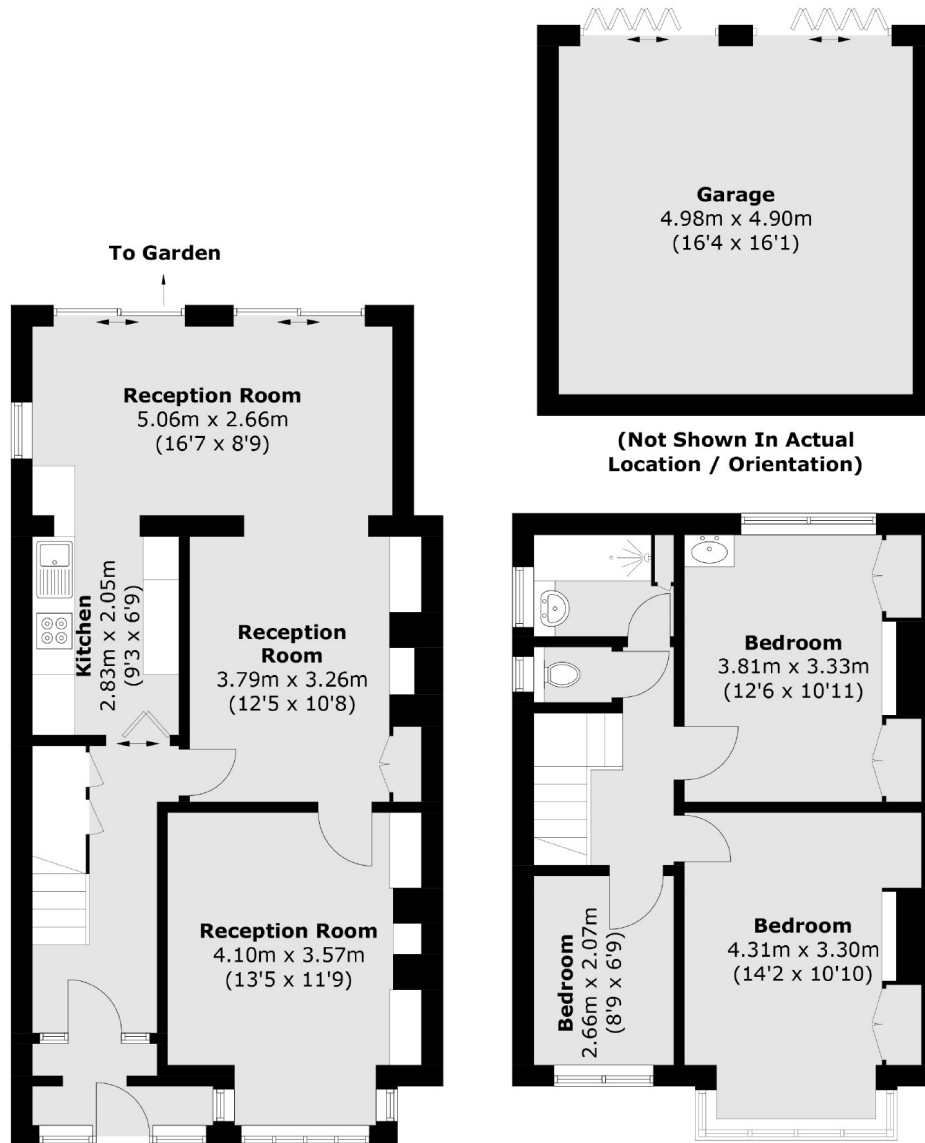

Total area (approx.): 102.7 sq. m (1,105.4 sq. ft)
Garage (approx.): 25.0 sq. m (269.1 sq. ft)

Snellers Hampton Hill Sales
197-201 High Street
Hampton Hill
TW12 1NL
020 8783 0083
hamptonsales@snellers.co.uk

Energy Rating: D We aim to make our particulars both accurate and reliable. However they are not guaranteed; nor do they form part of an offer or contract. If you require clarification on any points then please contact us, especially if you're traveling some distance to view. Please note that appliances and heating systems have not been tested and therefore no warranties can be given as to their good working order