

# SNELLERS

ESTATE AGENTS



**Stewart Close, TW12**

**£425,000**

Situated within a popular residential cul-de-sac is this semi-detached family home offering approximately 650 sq ft of accommodation over two floors. The property would suit first time buyers, professionals, families, investors or buyers looking for a safe and secure pied-a-terre.





The ground floor accommodation consists of an entrance porch, a spacious reception room incorporating distinct living and dining areas with a staircase leading to the first floor landing and a separate fitted kitchen with a uPVC double glazed door leading to the rear garden.

The first floor accommodation consists of a landing, a principal double bedroom, a second double bedroom with a recessed storage cupboard and a separate family bathroom.

Outside to the front is a garden which is mostly laid to lawn with shrub displays and a tree, a courtesy path provides side access via wooden gate to the rear. To the rear is a garden which is mostly laid to lawn with flower and shrub borders and displays, rest laid to patio, a part glazed door provides access to a single semi-detached garage with additional resident and visitor parking to the front accessed from a shared service road to the side.

Stewart Close forms part of the popular Nurserylands development and is ideally located for a number of schools and the recreational amenities of Hampton Common and Hatherop Park. The property is conveniently positioned for a local Sainsbury's Superstore, Hampton Station, Hampton Pool and Royal Bushy Park.

- Two Double Bedrooms • Spacious Reception Room • Fitted Kitchen •
- Family Bathroom • Private Rear Garden • Garage & Parking •







# SNELLERS

ESTATE AGENTS

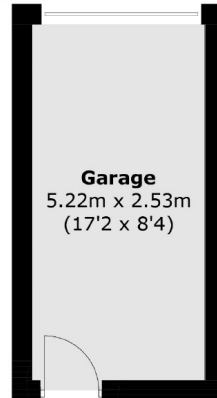

(Not Shown In Actual  
Location / Orientation)

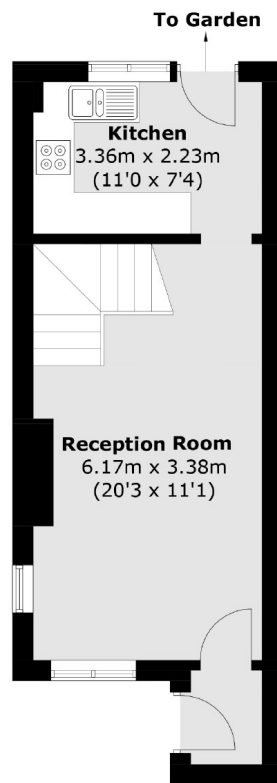

**Ground Floor**

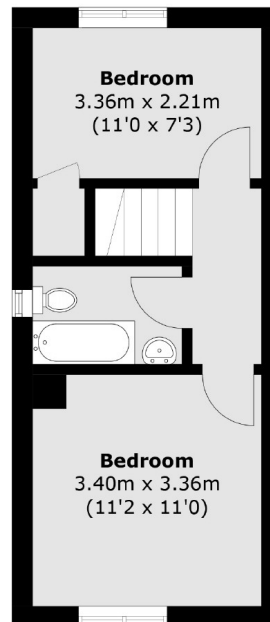

**First Floor**

Total area (approx.): 58.9 sq. m (634.0 sq. ft)  
Garage : 13.3 sq. m (143.1 sq. ft)

Snellers Hampton Hill Sales  
197-201 High Street  
Hampton Hill  
TW12 1NL  
020 8783 0083  
hamptonsales@snellers.co.uk

Energy Rating: C We aim to make our particulars both accurate and reliable. However they are not guaranteed; nor do they form part of an offer or contract. If you require clarification on any points then please contact us, especially if you're traveling some distance to view. Please note that appliances and heating systems have not been tested and therefore no warranties can be given as to their good working order