



## Shepherds Bush Green, W12

### £300,000

This well presented one bedroom flat in this purpose built block is West-facing and offers abundant natural light. The apartment has a good size open-plan reception room/kitchen, a double bedroom and has been meticulously cared for.

Centrally located in the heart of Shepherds Bush Green, this property is ideal for local transport links including Shepherds Bush station and the amenities of Westfield Shopping Centre.

### Features

- Chain Free
- Long Lease
- Fifth Floor
- Lift Service
- West Facing
- Central Line

# Shepherds Bush Green, London, W12

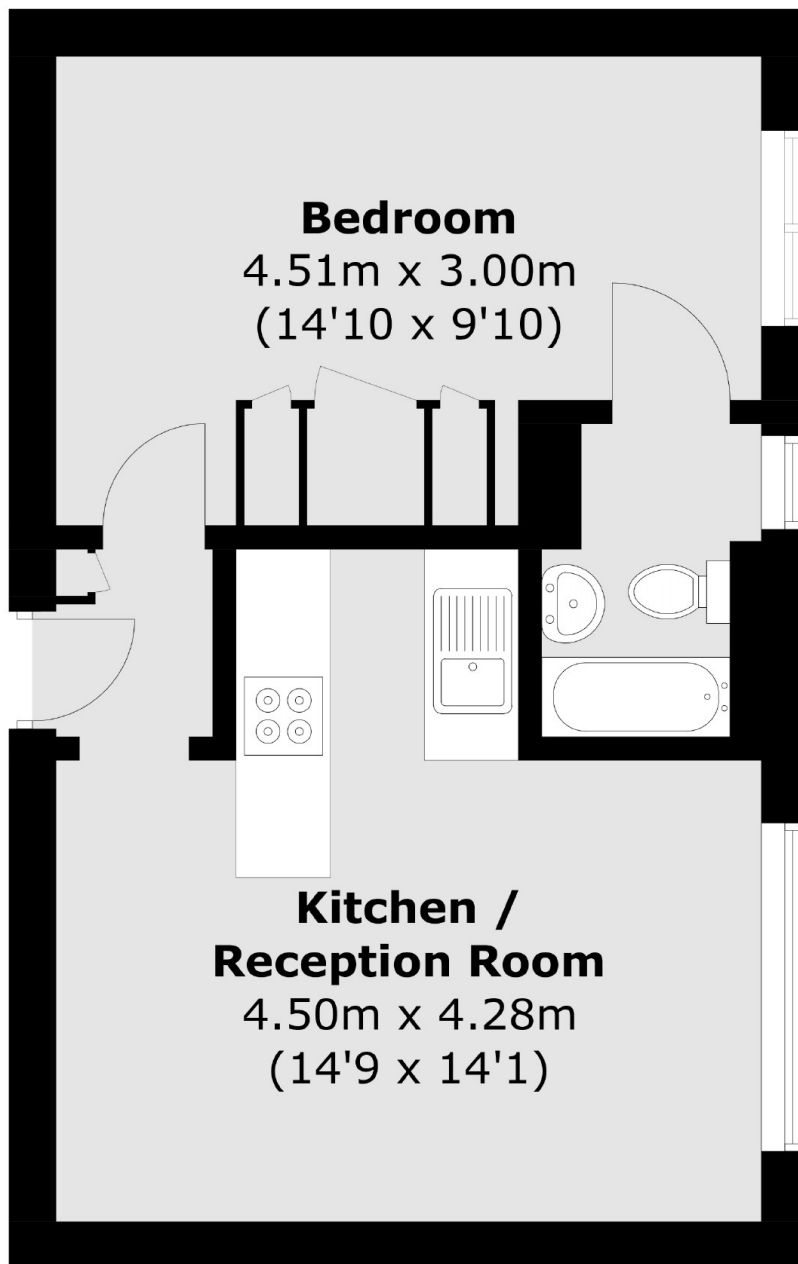

Total area (approx.): 33.6 sq. m (361.7 sq. ft)

**Dexters**

Shepherds Bush and Brook Green  
53 Shepherds Bush Green  
London  
W12 8PS  
Sales  
020 8740 2900

Energy Rating: C. We aim to make our particulars both accurate and reliable. However they are not guaranteed; nor do they form part of an offer or contract. If you require clarification on any points then please contact us, especially if you're traveling some distance to view. Please note that appliances and heating systems have not been tested and therefore no warranties can be given as to their good working order.

 **RICS** | Regulated  
Estate Agent  
and Letting Agent

dexters.co.uk