



## Uxbridge Road, W12

£392 Per week

A well-presented one-bedroom flat situated above commercial premises, finished to a good standard throughout. The property offers a spacious main room with ample space for living and dining, complemented by a compact open-plan kitchenette. The bedroom is well-proportioned and the overall layout is ideal for comfortable, low-maintenance living. Bright, neatly finished and thoughtfully arranged, this apartment is perfectly suited to a single professional seeking a convenient and well-connected home in a vibrant West London location.

The property is ideally located on Uxbridge Road, W12, just moments from Shepherd's Bush Market Underground Station (Hammersmith & City and Circle lines). From the station, turn right onto Uxbridge Road and continue for a short walk; the property is conveniently positioned along this main thoroughfare. The area benefits from an excellent range of local amenities including supermarkets, cafés, restaurants and independent shops. Westfield London is also within easy reach, offering extensive retail, dining and leisure facilities. Transport links are excellent, with easy access to Shepherd's Bush Market, Shepherd's Bush Central Line station, and multiple bus routes providing swift connections into Central London, Hammersmith, Notting Hill and beyond.

### Features

- One Bedroom
- Kitchenette
- Neutral Colours throughout
- Shower over bath
- Transport (Easy Access)

Uxbridge Road,  
London, W12

## Second Floor

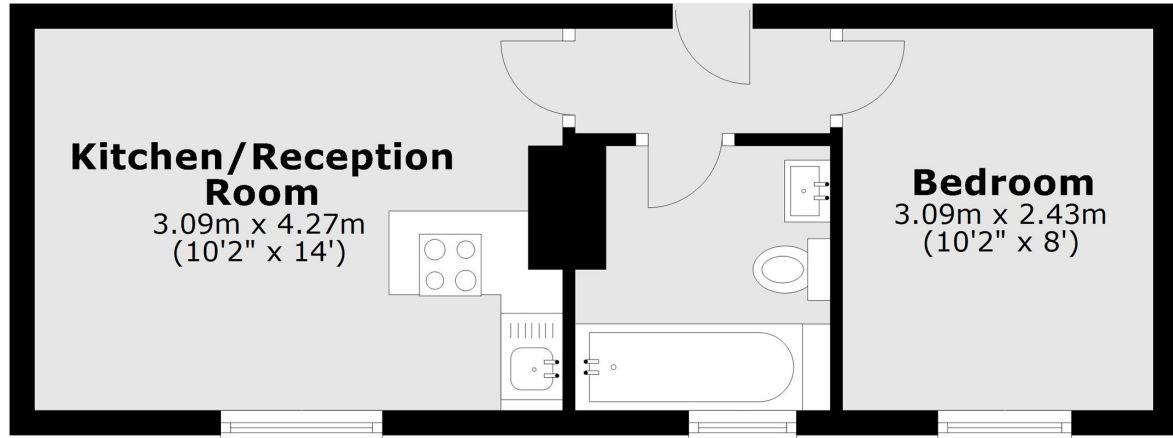

**Main area: Approx. 28.0 sq. metres (301.0 sq. feet)**  
Plus storage, approx. 2.7 sq. metres (28.8 sq. feet)