



Milson Road, W14

£452 Per week

This apartment is located on the ground floor of a Victorian conversation and has a large bedroom with bay window, reception with period features and large private garden.

Milson Road runs through the heart of the Brook Green with local amenities within a short walk. High Street Kensington and Holland Park are also a short walk away.

Features

- Brook Green
- One Bedroom
- Private Garden
- Period Features
- Wood Floors Throughout
- Separate Kitchen

Milson Road, London, W14

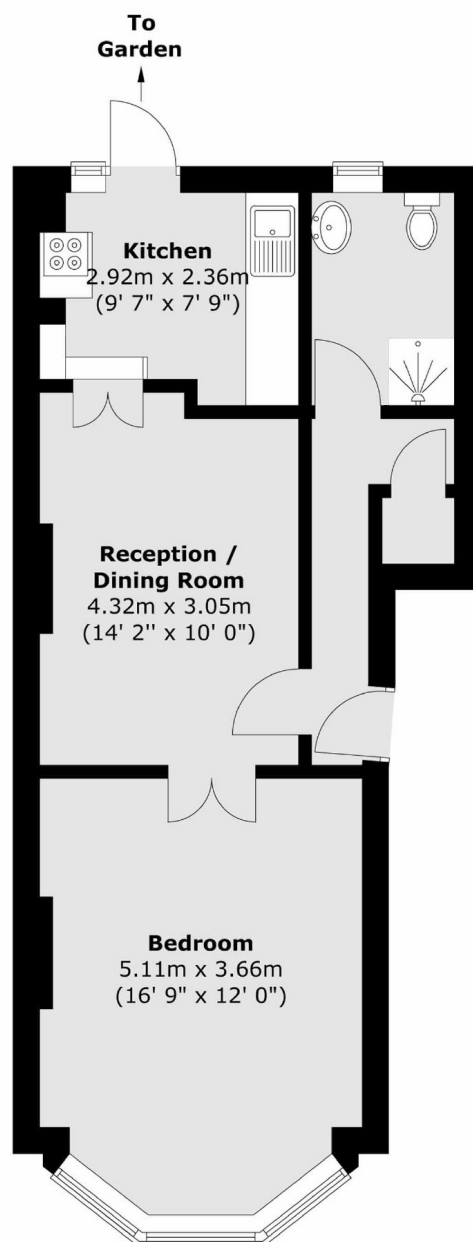

Total area (approx.) : 47.9 sq. m (516 sq. ft)