



Bolingbroke Road, W14

£475,000

A well presented one bedroom apartment on a highly desirable street in Brook Green. This property has a double bedroom, spacious bathroom, an open plan kitchen, living and dining space with door leading to a secluded garden.

Bolingbroke Road is in the heart of Brook Green. Shepherds Bush, Kensington Olympia and Hammersmith Stations are all close by, as well as Westfield Shopping Centre.

Features

- One Bedroom
- Share of Freehold
- Patio & Garden
- Desirable Road
- No Chain
- Brook Green

Bolingbroke Road, London, W14

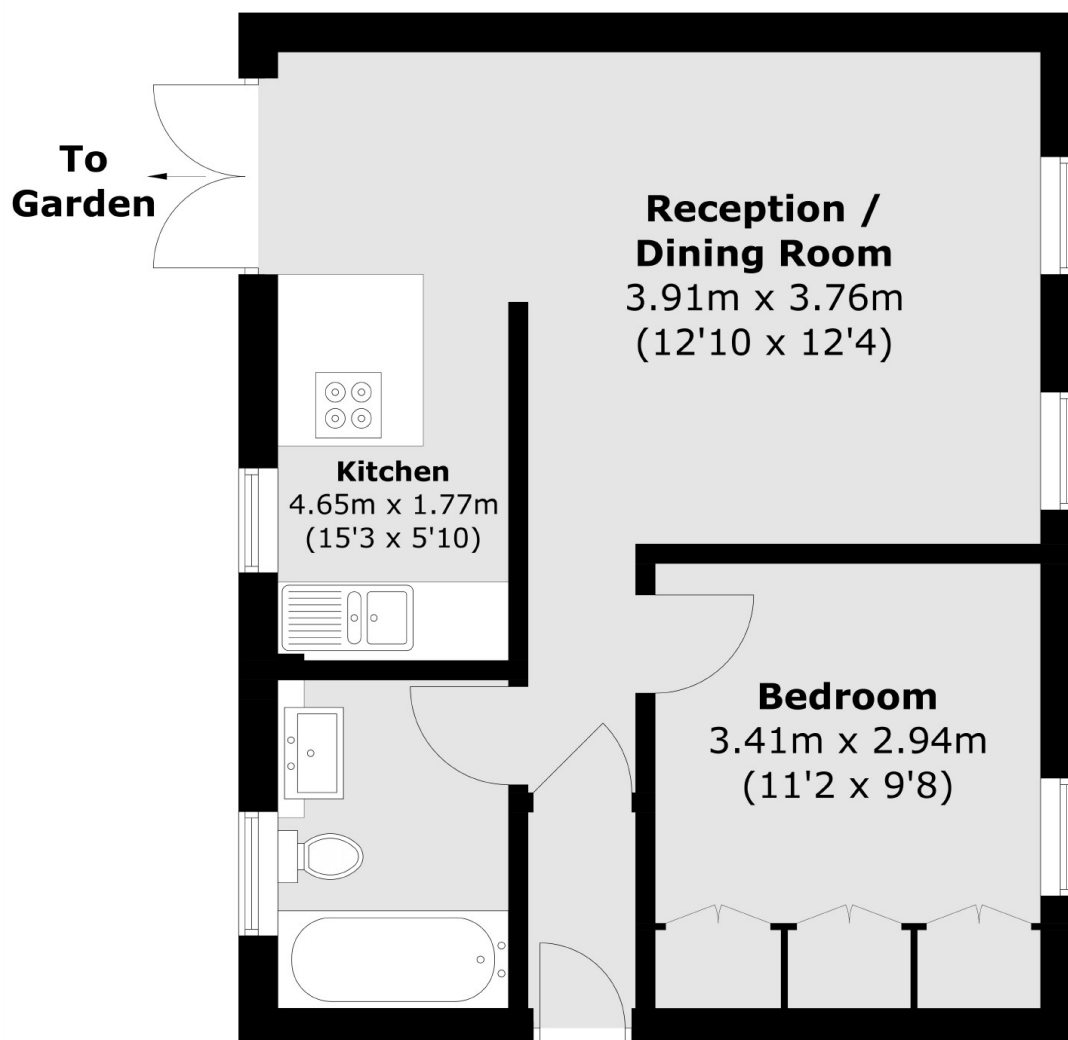

Total area (approx.): 42.9 sq. m (461.8 sq. ft)