



## Batman Close, W12

### £450,000

A fully refurbished two bedroom apartment situated next to Hammersmith Park. This beautiful property has been well presented throughout and has two double bedrooms, separate kitchen and living rooms, family bathroom and ample storage.

The property is close to White City, Wood Lane and Shepherds Bush Stations (Central, Circle, Hammersmith & City & Overground). All the amenities of Westfield Shopping Centre, Television Centre/Soho House & Hammersmith Japanese garden are all a short walk.

### Features

- Two Double Bedrooms
- Private Balcony
- Fully Refurbished
- No Chain
- Hammersmith Park
- Westfield Shopping Centre

# Batman Close, London, W12

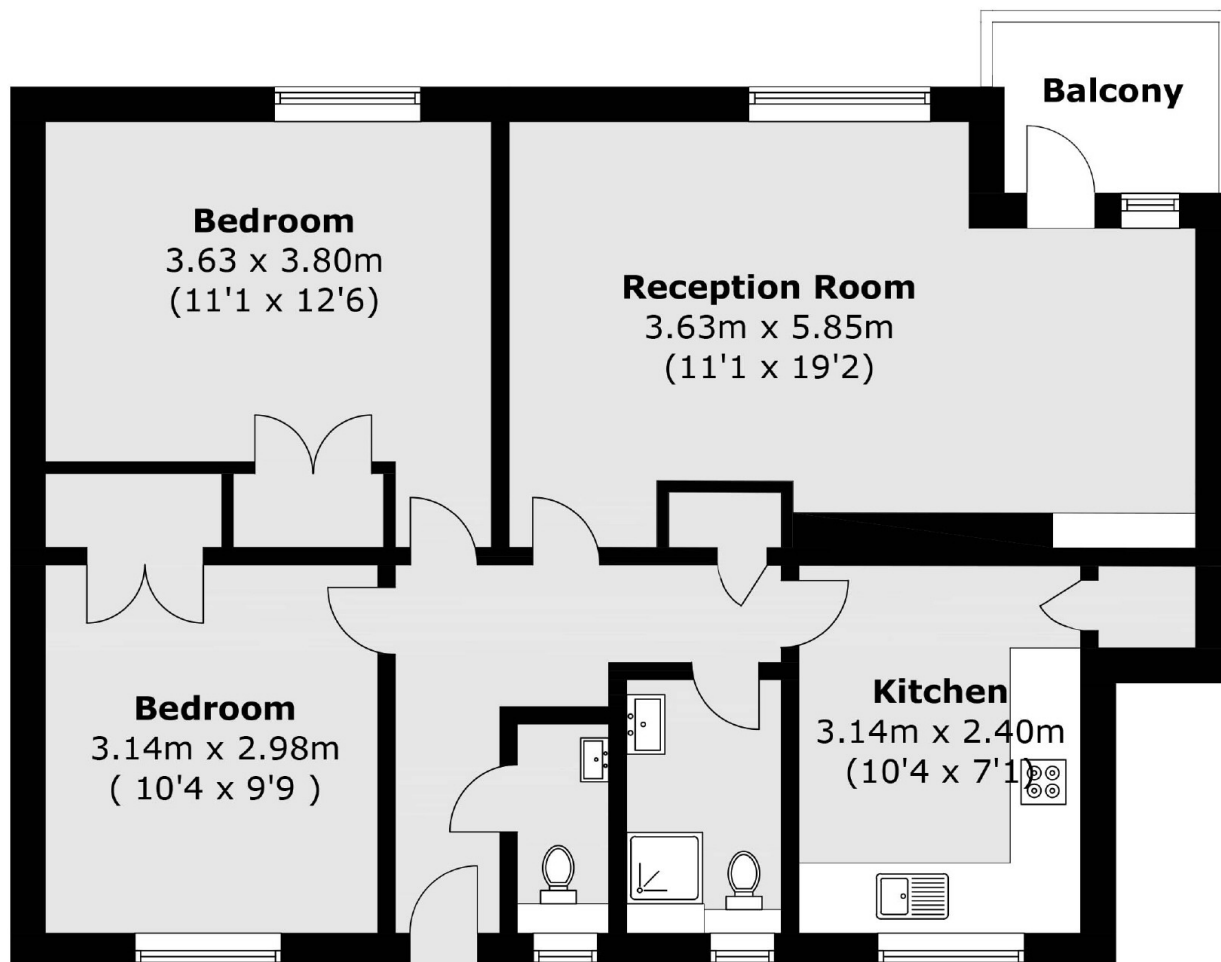

Total area (approx.): 63.7 sq. m (685.6 sq. ft)

Balcony area (approx.): 2.7 sq. m (29.1 sq. ft)