



Shepherd's Bush Green, W12

£180,000

On the ground floor of this Art Deco Block is this spacious studio apartment. This property would be a great investment or pied a terre and has the opportunity to make it your own.

Romney Court is located a close to the Central Line giving easy access into Central London. The local amenities of Westfield Shopping Centre are a short walk away.

Features

- Studio Apartment
- Westfield Shopping Centre
- Central Line
- Ground Floor
- Lift Access
- No Onwards Chain

Shepherds Bush Green, London, W12

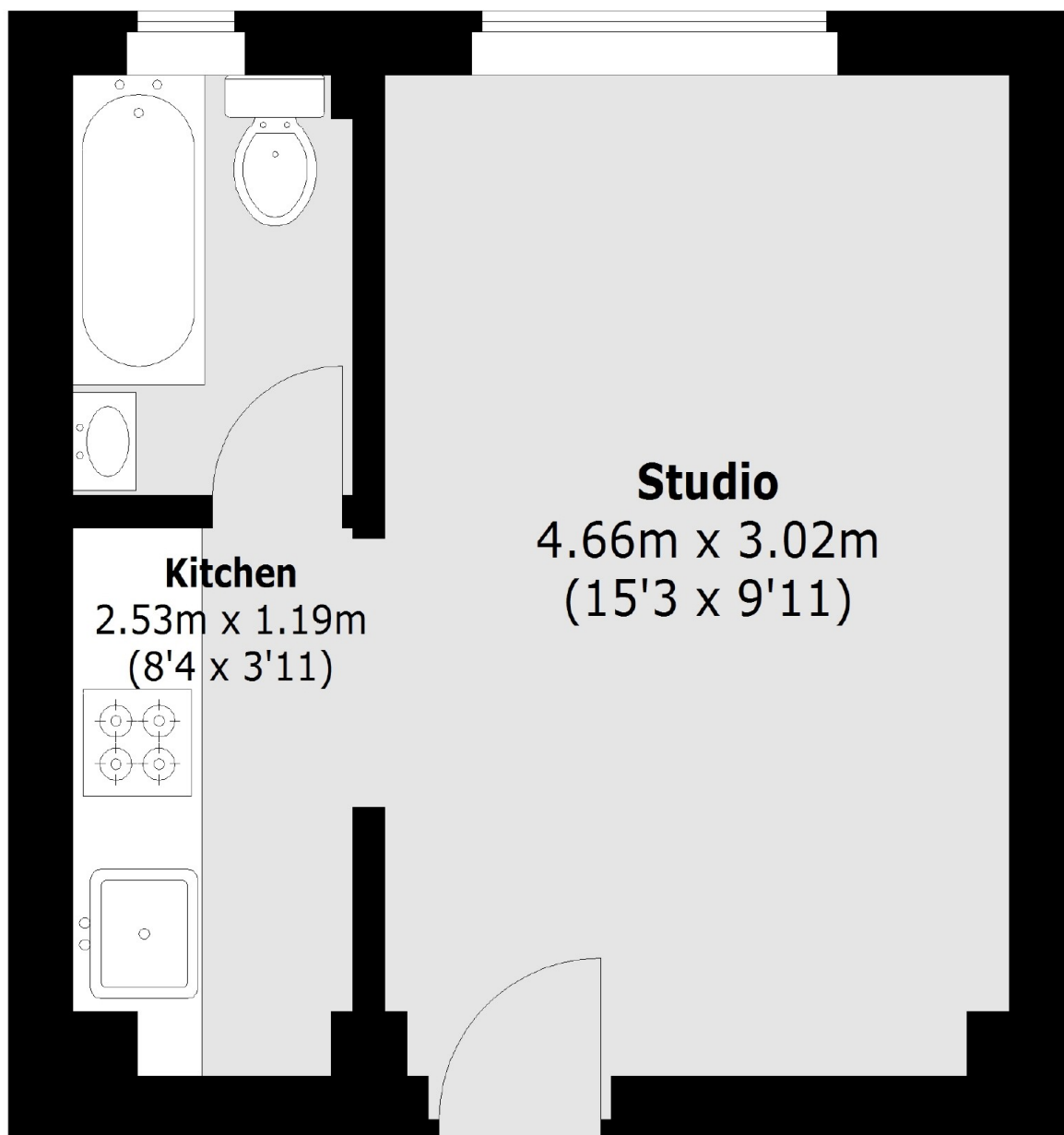

Total area (approx.): 20.40 sq. m (219.5 Sq. ft)