



## Sulgrave Road, W6

£550,000

A well presented one bedroom garden flat on popular tree lined road. This property has a reception room with a bay window, a semi open plan kitchen and a spacious bedroom with bi-folding doors into private garden with outhouse.

Located on Sulgrave Road just off Shepherds Bush Road the property is very close to both Goldhawk Road and Shepherds Bush Underground stations. There are also plenty of bus routes down to Hammersmith Broadway. The Westfield London shopping centre is nearby.

### Features

- One Bedroom
- Period Conversion
- Private Garden
- Bay Window
- Bi-Folding Doors
- Westfield Shopping Centre

# Sulgrave Road, London, W6

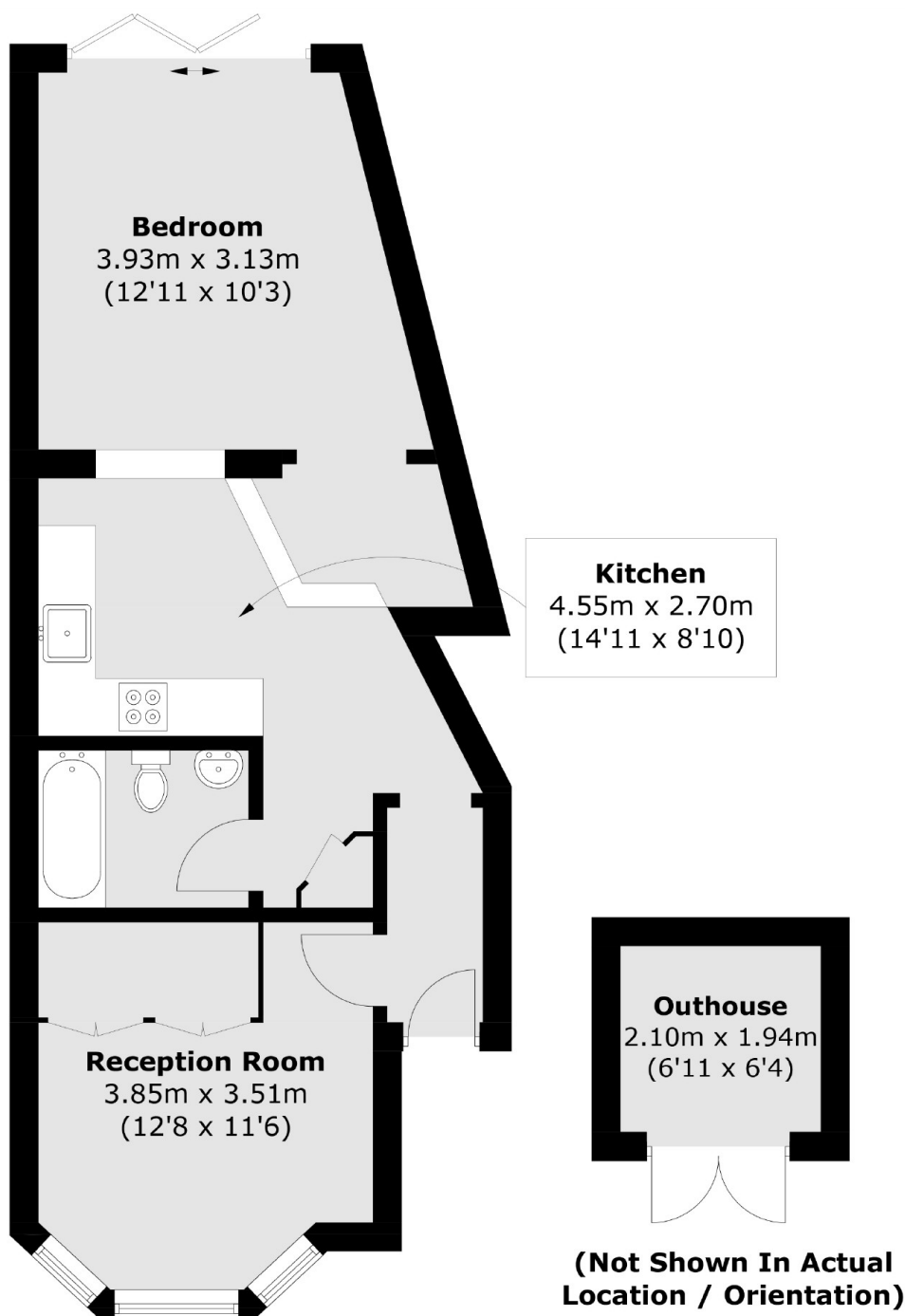

Total area (approx.): 50.2 sq. m ( 540.3 sq. ft)  
Outhouse area (approx.): 4.3 sq. m ( 46.3 sq. ft)