



Sinclair Gardens, W14

£435,000

An art deco purpose built apartment on Sinclair Gardens within the popular Brook Green Area. This property is well presented throughout with two double bedrooms, living room, separate kitchen and bathroom.

Clandon Court is located in the sought after area of Brook Green close to the cafes and restaurants. Westfield Shopping Centre is nearby along with the green space of Holland Park.

Features

- Two Bedrooms
- Art Deco Building
- Chain Free
- Brook Green
- Westfield Shopping Centre
- Transport Links

Sinclair Gardens,
London, W14

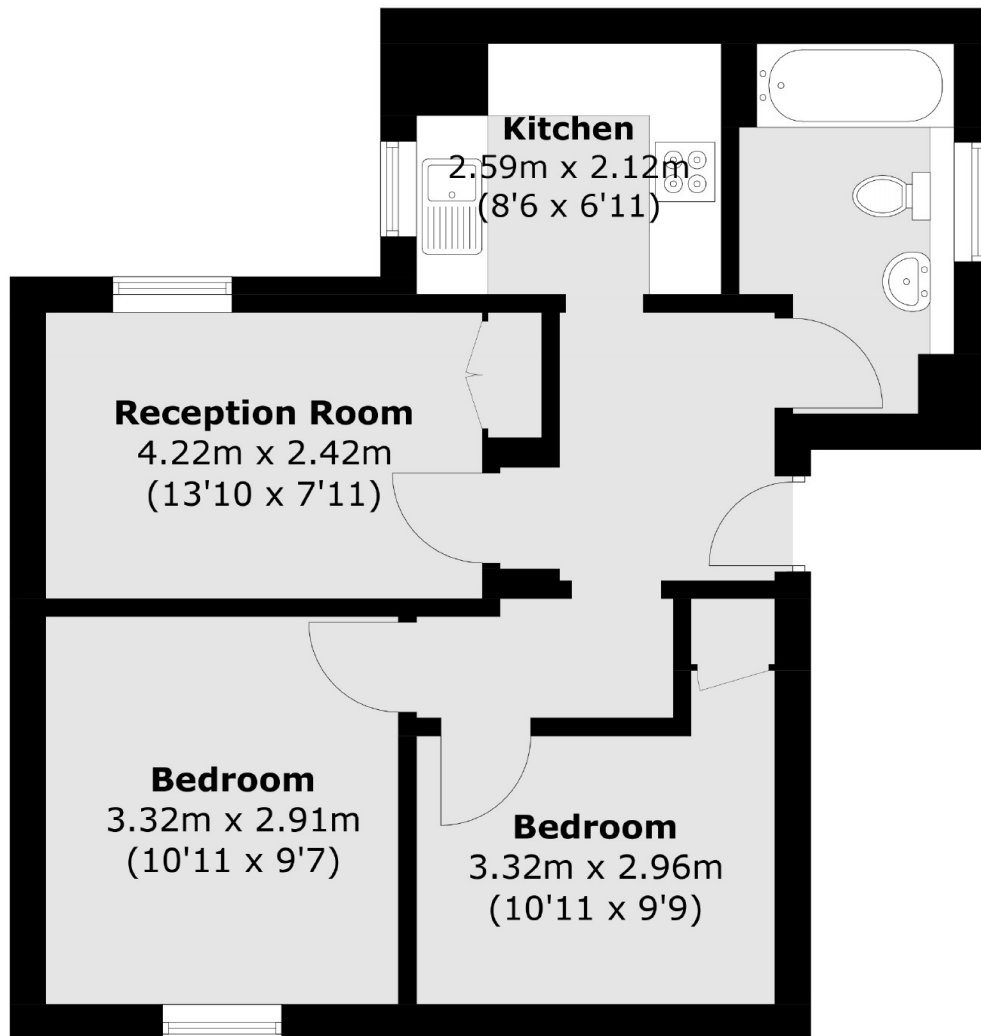

Total area (approx.): 46.9 sq. m (504.8 sq. ft)