



Bulwer Street, W12

£300,000

A spacious one bedroom flat in a private block in the heart of Shepherds Bush. This property has an open plan kitchen and living room, one double bedroom, bathroom and access to shared garden.

Bulwer Street is located moments from the local amenities of Westfield Shopping Centre. Access into Central London is a stone's throw away.

Features

- One Bedroom
- Open Plan Kitchen/Living
- Central Line
- Shared Terrace Garden
- New Lease Granted
- Westfield Shopping Centre

Bulwer Street, London, W12

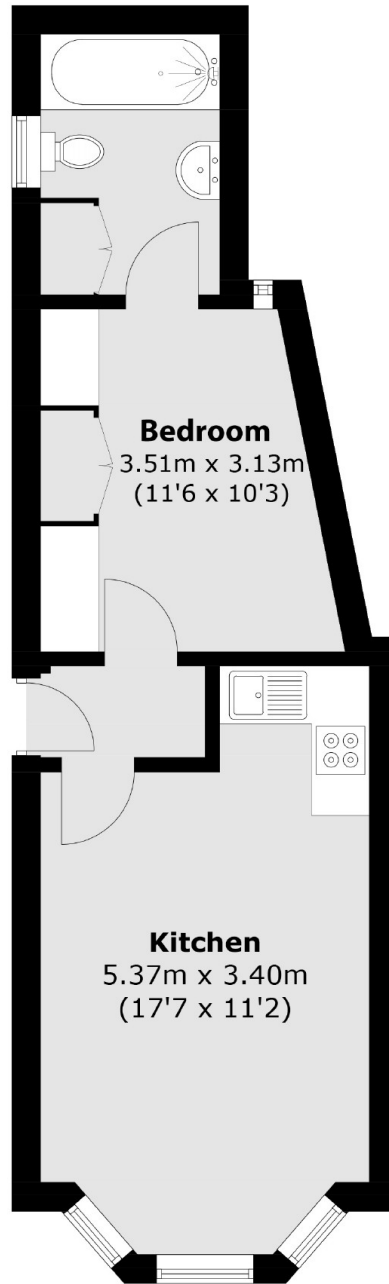

Total area (approx.): 35.5 sq. m (382.1 sq. ft)