



Sinclair Road, W14

£1,580,000

A wonderful three bedroom flat set over two floors in an ideal Brook Green location. This property has a spacious reception room, separate kitchen and private garden.

Sinclair Road is located in the sought after area of Brook Green close to the local cafes and restaurants. The green space of Holland Park and the shops of High Street Kensington are a short walk away.

Features

- Three Bedrooms
- Split Level
- Character Features
- Over 1700sqft
- Private Garden
- Brook Green



Sinclair Road, W14

This spectacular flat occupies the ground and lower ground floor of this Victorian property. Full of period charm and character features throughout. It benefits from large proportions, wonderful high ceilings and wooden flooring with the potential to really make this property your home.

The property measures over 1700sqft has a two grand reception rooms on the raised ground floor leading down on to private garden. On the lower ground the flat has three bedrooms, two large bathrooms and ample storage on offer with additional access to the garden from this level.

This property is full of character and would make a truly incredible opportunity for any buyer who purchases it.



Sinclair Road, London, W14

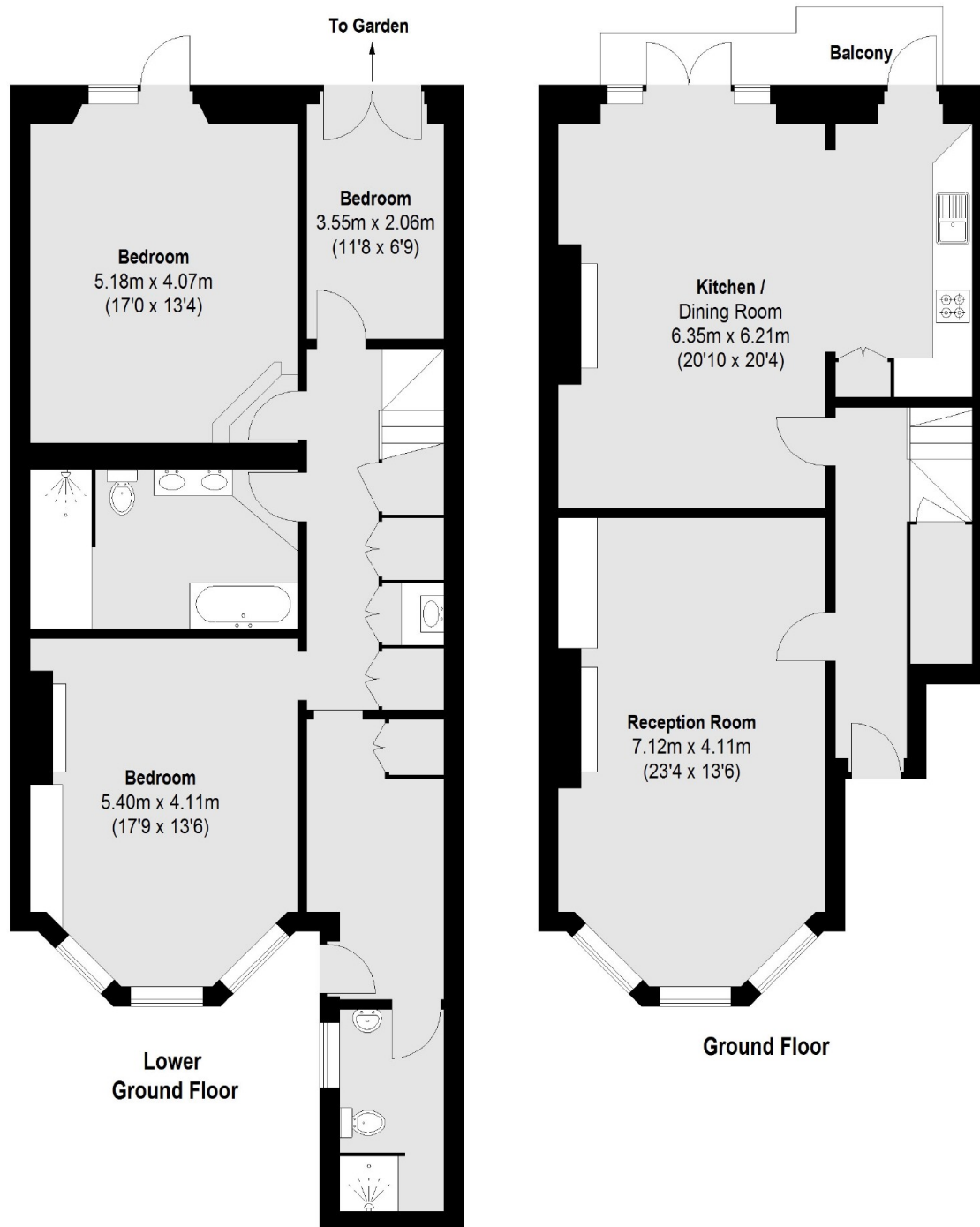

Total area (approx.): 165.25 sq. m (1778 Sq. ft)
Balcony: 5.10 sq. m (55 Sq. ft)