

Lexham Gardens, W8

£350 Per week

A self contained studio with high ceilings and private patio situated on the lower ground floor of period building with a fully fitted kitchen and wood flooring throughout.

Lexham Gardens is a premier street in Kensington, within close proximity to High Street Kensington, Hyde Park, Gloucester Road and Earl's Court tube stations, with easy access to the A4 and central London.

Features

- Studio
- Private Patio
- Open Plan
- Self Contained
- Wood Floors
- Period Building

Lexham Gardens, London, W8

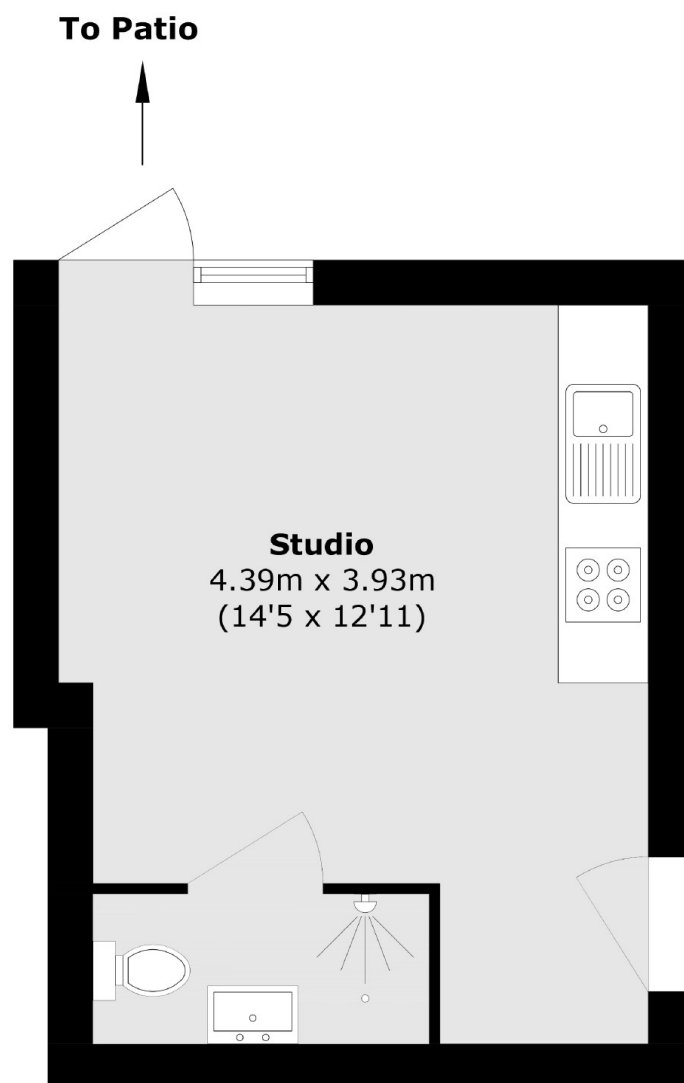

Total area (approx.): 19.2 sq. m (206.6 sq. ft)