

Cromwell Road, SW5

£634 Per week

A stunning one bedroom flat located in the sought after portered development Sherborne Court. The flat is situated on the third floor with a lift and benefits from having its own private balcony with great views.

Sherborne Court is conveniently located on Cromwell Road. A five minute walk to the popular High Street Kensington and even closer to the amenities of Earls Court Road.

Features

- One Bedroom
- One Bathroom
- Wooden Floors
- Porter
- Balcony
- Lift

Cromwell Road,
London, SW5

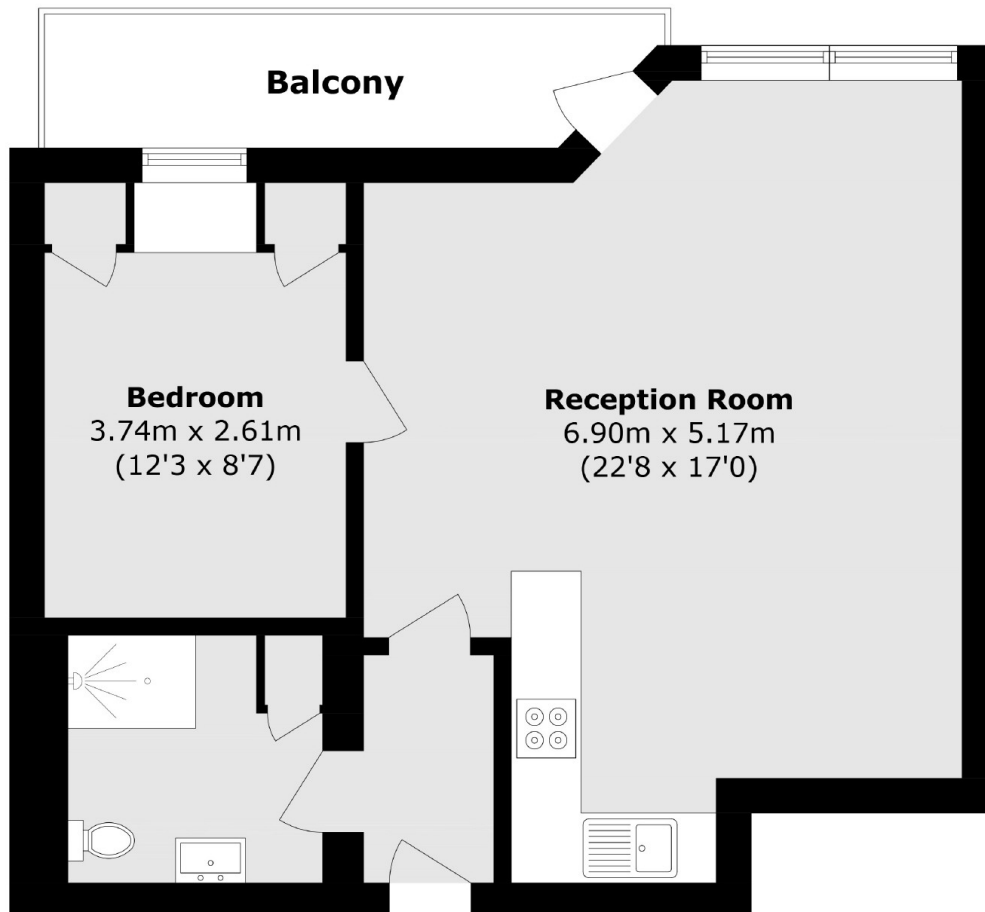

Total area (approx.): 48.1 sq. m (517.7 sq. ft)
Balcony area(approx.): 5.6 sq. m (60.2 sq. ft)

Dexters

Earl's Court
3 Hogarth Place
London
SW5 0QT
Lettings
020 7370 3030

Energy Rating: . We aim to make our particulars both accurate and reliable. However they are not guaranteed; nor do they form part of an offer or contract. If you require clarification on any points then please contact us, especially if you're traveling some distance to view. Please note that appliances and heating systems have not been tested and therefore no warranties can be given as to their good working order.

 **RICS** | Regulated
Estate Agent
and Letting Agent

[dexters.co.uk](https://www.dexters.co.uk)