



Earls Court Road, SW5

£634 Per week

A recently refurbished two bedroom apartment on the third floor of a purpose built portered block, in the heart of Earls Court with wood floors and lift access.

Sullivan Court can be accessed either via Earls Court Road or Redfield Lane. There are a wide selection of bus routes and the closest underground station is Earls Court.

Features

- Two Double Bedrooms
- Wood Floors
- Separate Fitted Kitchen
- Porter
- Lift
- Close to Transport

Earls Court Road,
London, SW5

Third Floor

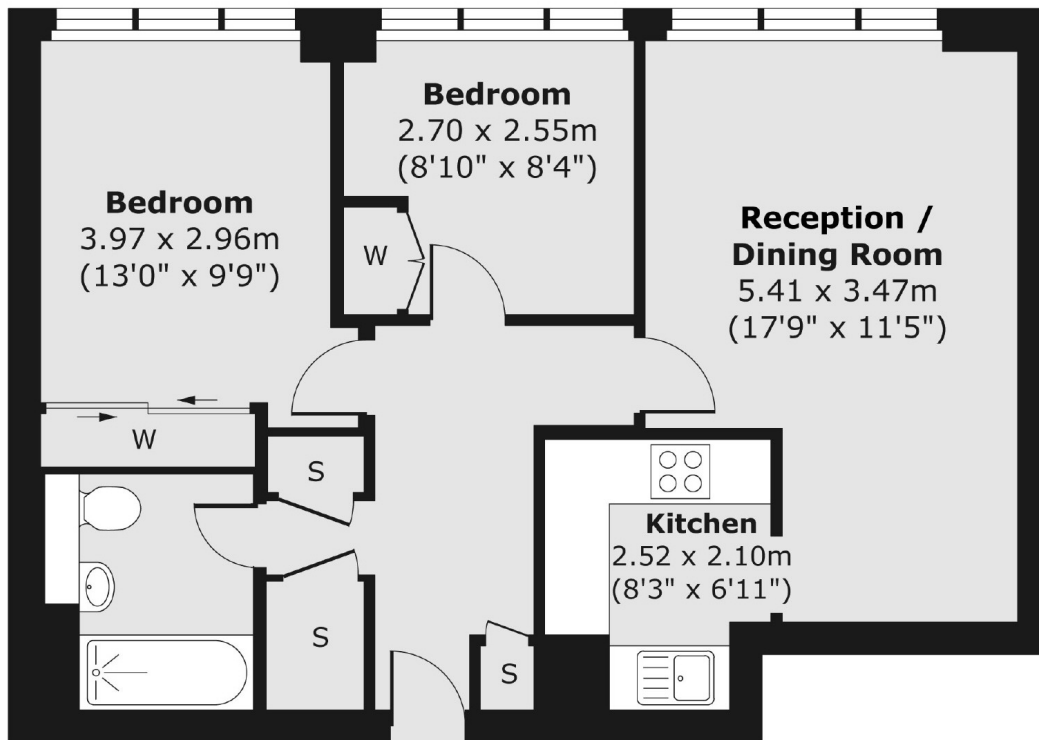

Total area (approx.) 54.27 sq. m (584 sq. ft)