



Cromwell Road, SW5

£525 Per week

A well presented and spacious one bedroom apartment situated in a purpose built block. The flat has a large open plan kitchen reception room with wooden flooring throughout.

The property is very well located for amenities and transport links of both Gloucester Road and Earl's Court, with Gloucester Road tube station only 0.3 miles away.

Features

- One Bedroom
- Modern Finish
- Lower Ground
- Hard Wood Flooring
- Close To Amenities
- Open Plan Kitchen

Cromwell Road,
London, SW5

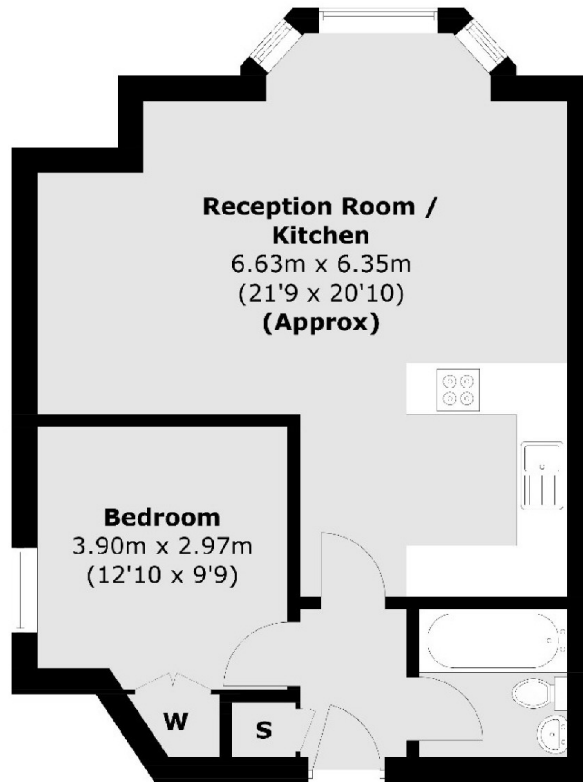

Total area (approx.): 48.1 sq. m (517.7 sq. ft)

Dexters

Earl's Court
3 Hogarth Place
London
SW5 0QT
Lettings
020 7370 3030

Energy Rating: E. We aim to make our particulars both accurate and reliable. However they are not guaranteed; nor do they form part of an offer or contract. If you require clarification on any points then please contact us, especially if you're traveling some distance to view. Please note that appliances and heating systems have not been tested and therefore no warranties can be given as to their good working order.

 **RICS** | Regulated
Estate Agent
and Letting Agent

[dexters.co.uk](https://www.dexters.co.uk)