



Cromwell Road, SW5

£485 Per week

A modern studio based on the 3rd floor (with lift) of this sought after development. Benefits include private balcony, 24hr security and the heating & hot water included in the rent - Parking at separate negotiation.

Sherborne Court is conveniently located on Cromwell Road. A five minute walk to the popular High Street Kensington and even closer to the amenities of Earls Court Road.

Features

- Heating & Hot Water Inc
- 24hr Security/Concierge
- Private Balcony
- Wood Flooring
- Breakfast Bar
- 3rd Floor with Lift

**Cromwell Road,
London, SW5**

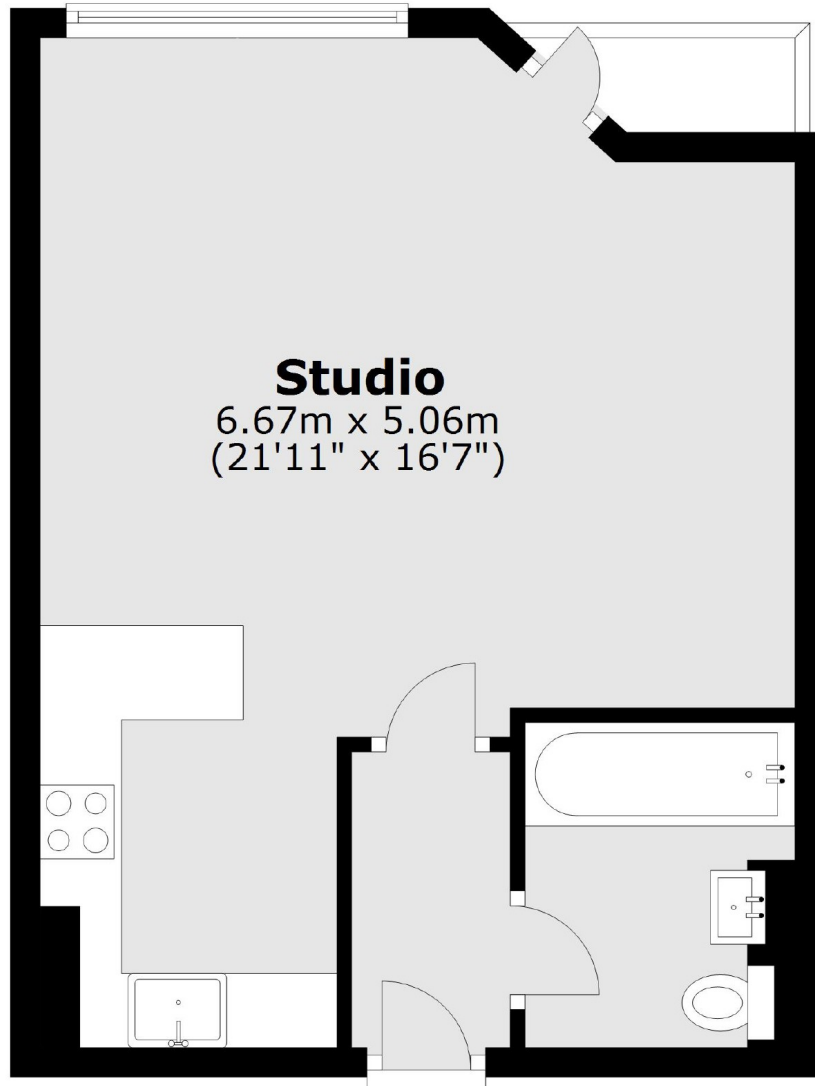

Total area: approx. 33.4 sq. metres (359.6 sq. feet)