



## Warwick Road, SW5

£395 Per week

A studio flat with plenty of natural light, separate kitchen and access to the communal gardens. All of this make the flat a great option for a single or professional couple.

A great location for commuters and those looking to be close to the action. Close to a 24hr supermarket, shops, bars, restaurants and of course the tube station.

### Features

- Studio
- Separate Kitchen
- Naturally Bright
- Communal Garden Access
- Wood Flooring
- Close to Transport

**Warwick Road,  
London, SW5**

**Third Floor**

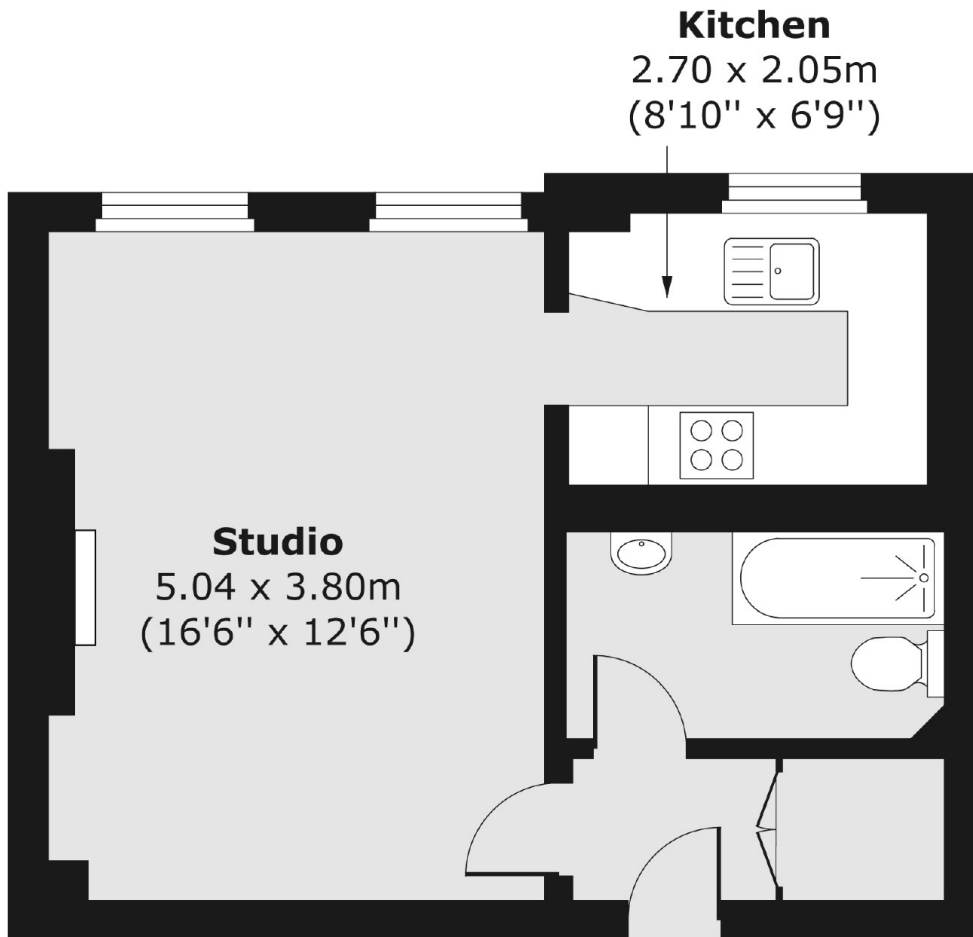

Total area (approx.) 34.04 sq. m (366 sq. ft)