



Warwick Road, W14

£775 Per week

A large two double bedroom apartment based on the second floor with lift access. Benefits also include a large private garden, a separate kitchen and communal gardens.

The property is located between High Street Kensington and Earls Court, with the nearest tube station being 0.3 miles away (Piccadilly and District lines).

Features

- Two Double Bedrooms
- Large Private Garden
- Separate Eat-in Kitchen
- Floor to Ceiling Windows
- Communal Gardens
- Furnished

Warwick Road, London, W14

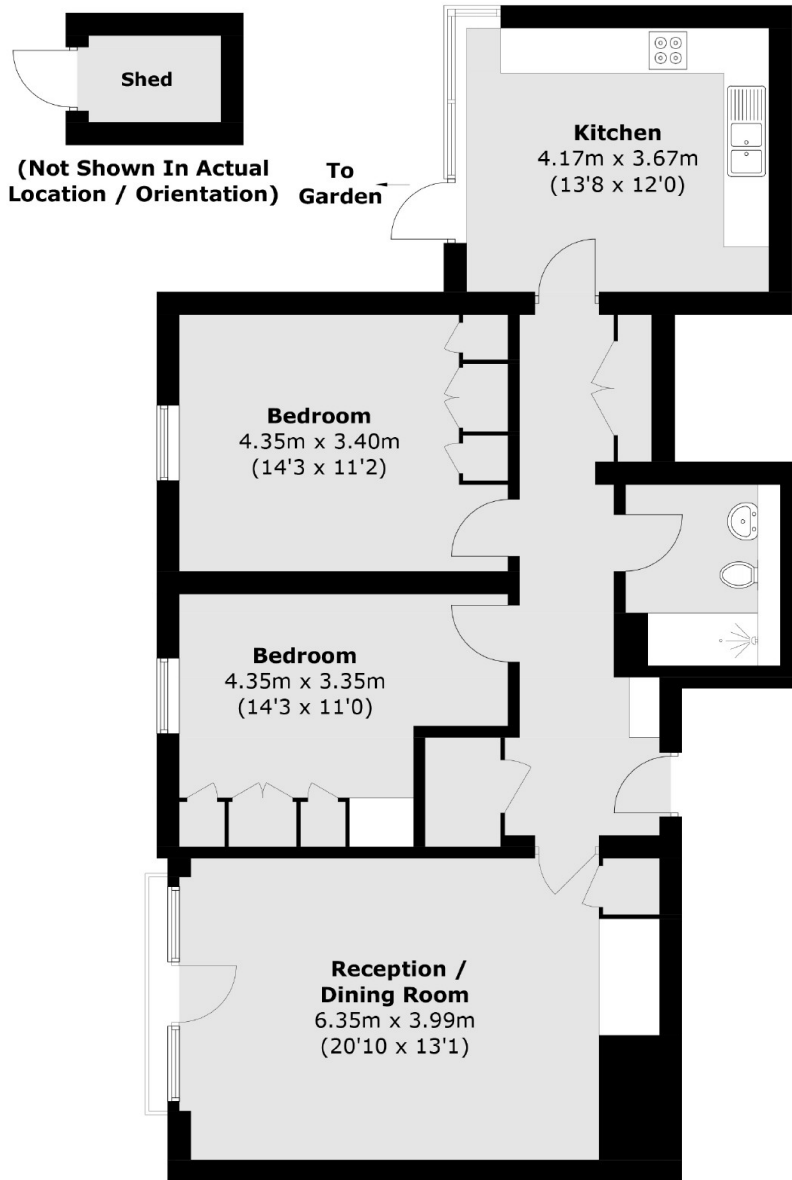

Total area (approx.): 89.9 sq. m (967.7 sq. ft)
Shed : 2.1 sq. m (22.6 sq. ft)