



## Lexham Gardens, W8

£553 Per week

Situated on the raised ground floor of a well kept period conversion, this one bedroom has period features throughout including high ceilings, feature fireplace and a beautiful bay window in the reception.

Lexham Gardens is perfectly located between Gloucester Road, Earls Court and High Street Kensington. Meaning you are well connected and spoilt for options when it comes to restaurants and shops.

### Features

- Raised Ground Floor
- Wood Floors Throughout
- High Ceilings
- Separate Kitchen
- Built In Storage
- Lexham Gardens

# Lexham Gardens, London, W8

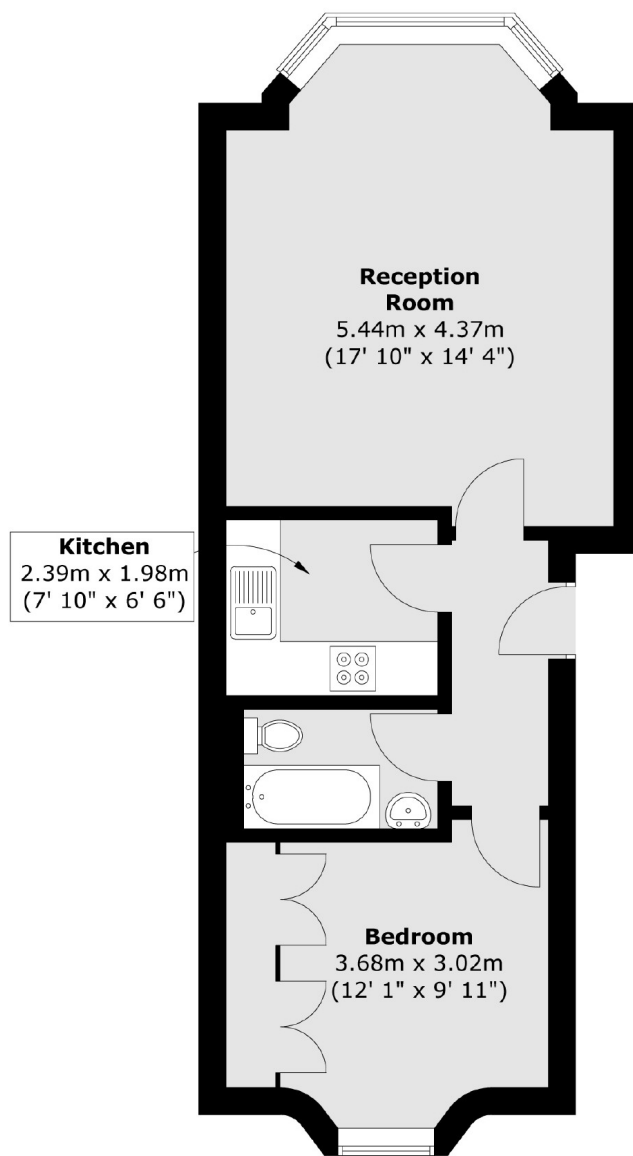

Total area (approx.) : 45.8 sq. m (493 sq. ft)