

## Beaumont Crescent, W14

£2,500 Per calendar month

A lovely, spacious raised ground floor apartment offering wooden flooring throughout, two good size bedrooms with storage, entertaining contemporary lounge leading into a kitchen with breakfast bar.

Beaumont Crescent is conveniently located with 200 yards to West Kensington underground station, local shops and the A4 for easy access into and out of central London.

### Features

- Two Bedrooms
- Raised Ground Floor
- Red Brick Building
- Close To Tube
- Eat In Kitchen
- Wooden Floors

# Beaumont Crescent, London, W14

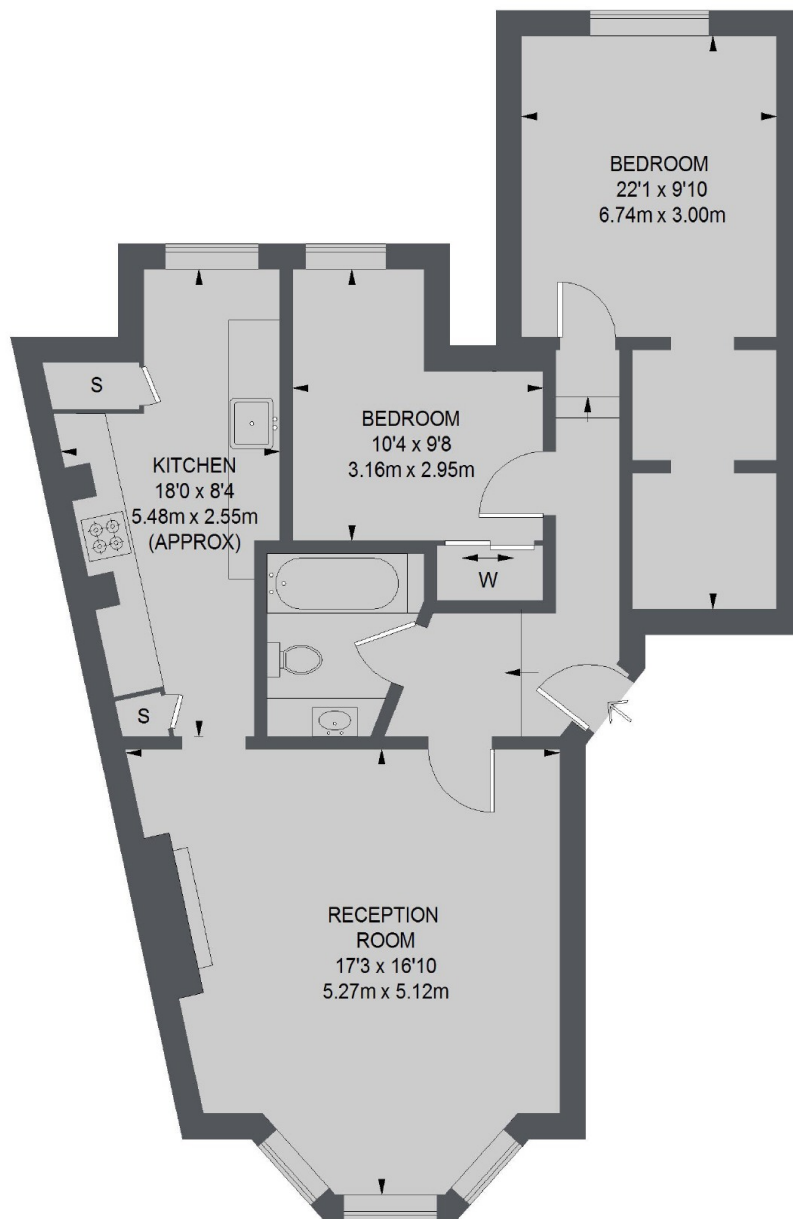

GROUND FLOOR

TOTAL APPROX. FLOOR AREA  
764 SQ. FT. (70.98 SQ. M.)

## Dexters

West Kensington  
179-181 North End Road  
London  
W14 9NL  
Lettings  
020 7381 4133

Energy Rating: D. We aim to make our particulars both accurate and reliable. However they are not guaranteed; nor do they form part of an offer or contract. If you require clarification on any points then please contact us, especially if you're traveling some distance to view. Please note that appliances and heating systems have not been tested and therefore no warranties can be given as to their good working order.

 **RICS** | Regulated  
Estate Agent  
and Letting Agent

[dexters.co.uk](https://www.dexters.co.uk)