



## Edith Villas, W14

£2,500 Per calendar month

AVAILABLE 23rd October. A beautifully presented top floor two bedroom flat, set within a secure 1930s mansion block with porter and lift service, moments from West Kensington underground station and featuring, a private balcony with stunning views.

West Kensington Court is conveniently located within 200 yards to West Kensington station and local shops and less than a mile to the numerous facilities in Kensington High Street.

### Features

- Two Bedrooms
- Top Floor
- Heating Included
- Hot Water Included
- Balcony
- Portered Building

# Edith Villas, London, W14

Sixth Floor

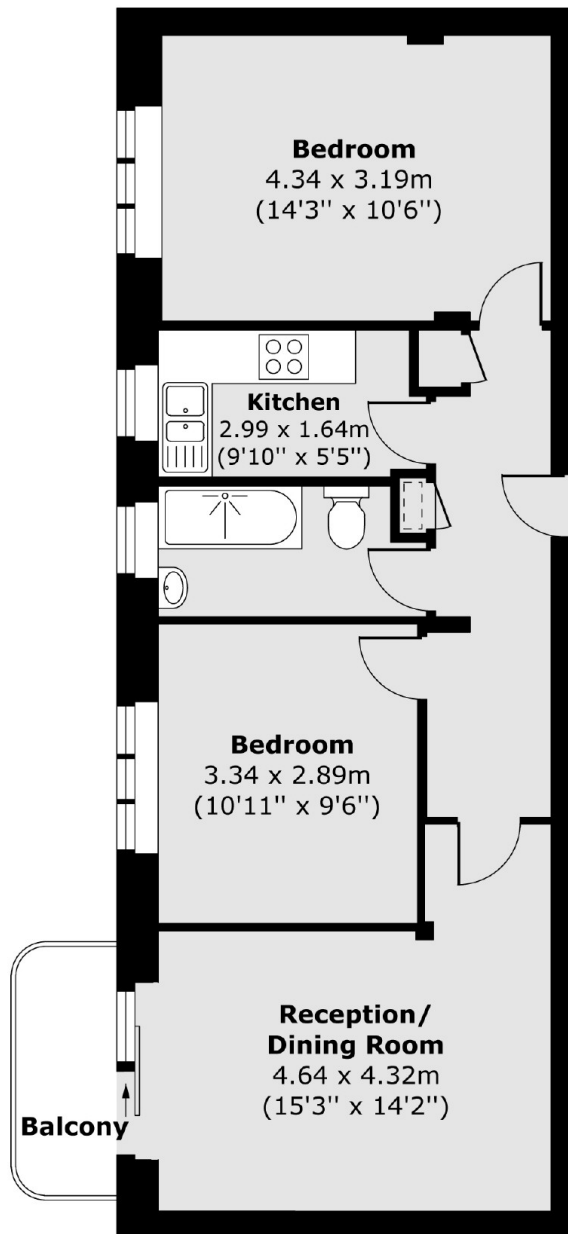

Total area (approx.) 57.84 sq. m (623 sq. ft)  
Balcony area (approx.) 3.10 sq. m (33 sq. ft)