



## Edith Road, W14

£3,750 Per calendar month

This three bedroom apartment on the first floor of a red brick mansions block offers good proportions throughout. With a separate kitchen, two balconies and ample storage space this property is ideal for a family looking for a home.

Edith Road is close to all the local shops, restaurants, cafés and transport links that Kensington Olympia, West Kensington, Barons Court and Hammersmith has to offer.

### Features

- Three Bedrooms
- Two Bathrooms
- First Floor Flat
- Red Brick Mansion Block
- Two Private Balconies
- Close to Barons Court Tube Station





**Edith Road, W14**





# Edith Road, London, W14

## Second Floor

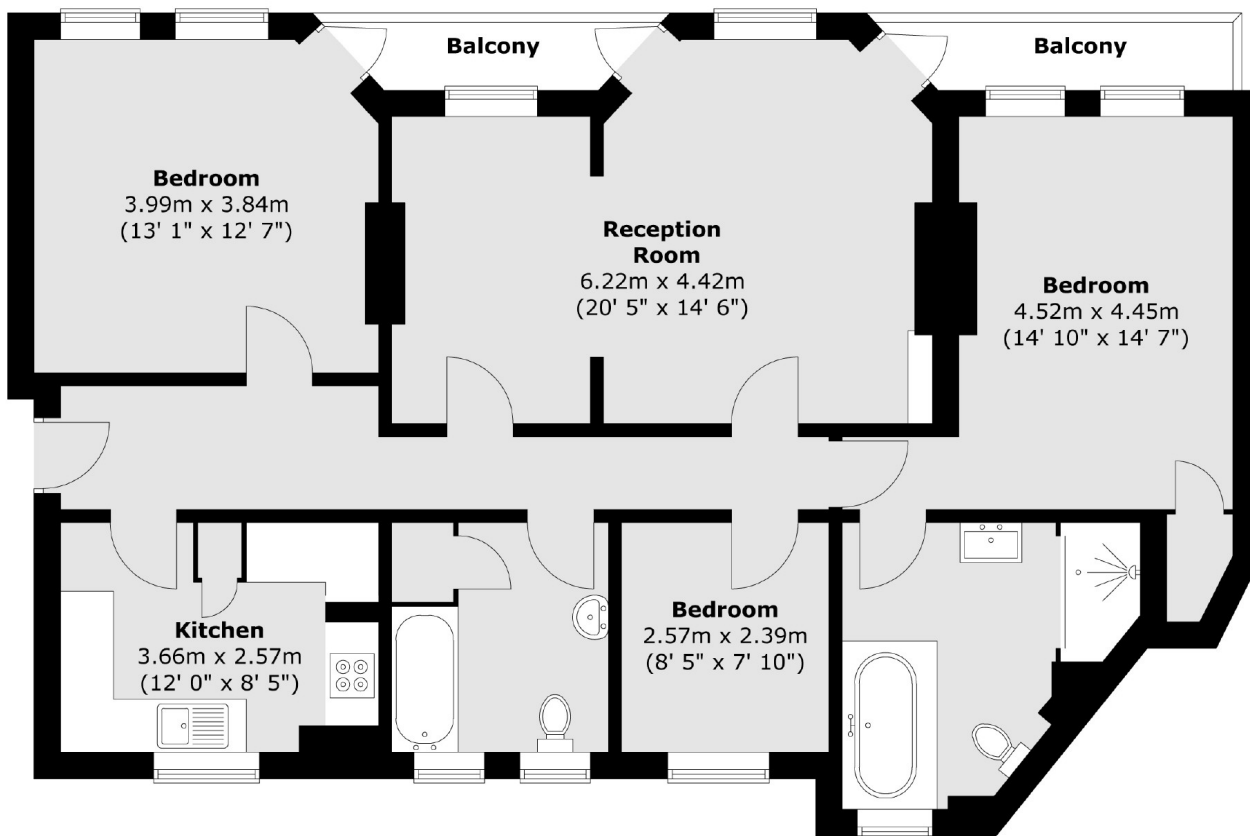

Total area (approx.) : 104.3 sq. m (1123 sq. ft)  
Total balcony area (approx.) : 5 sq. m (54 sq. ft)