



Gibbs Green, W14

£425,000

A fully refurbished two bedroom split-level apartment situated in a well maintained purpose built development. The property is ready to move in to, comes with a brand new lease and would make an ideal home or a rental investment.

Gibbs Green is located in the West Kensington estate and is best accessed off Beaumont crescent. Well placed for West Kensington and Barons Court underground station and the A4 for easy access into and out of central London.

Features

- Long Leasehold
- Two Bedrooms
- Spacious
- No Chain
- Split Level
- Close To Tubes

Gibbs Green, London, W14

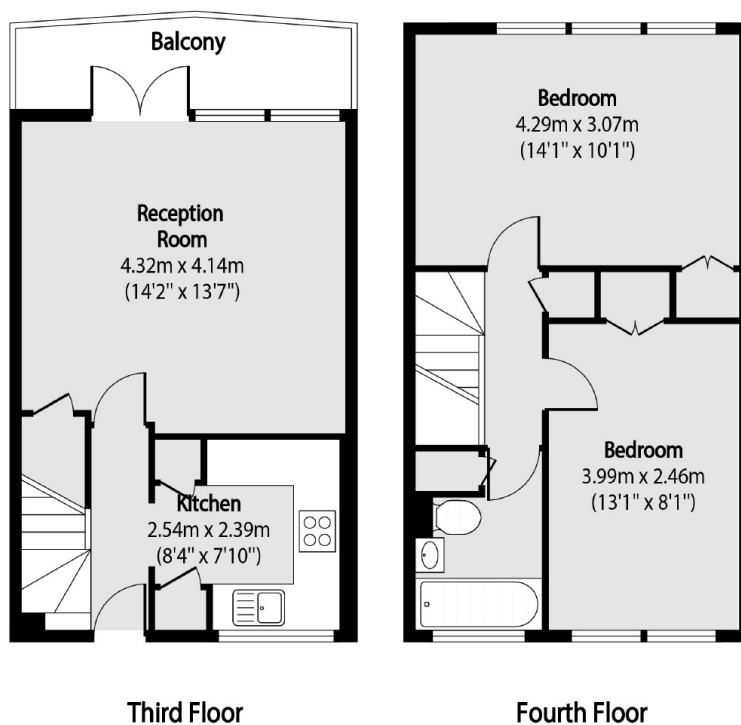

Total area (approx): 61.41 sq m (661 sq. ft)

Balcony total area (approx): 5.02 sq m (54 sq. ft)