



Beaumont Crescent, W14

£575,000

A modernised two bedroom apartment situated in a newly refurbished period building. This property has excellent light throughout with good space and an open plan living and kitchen area.

Beaumont Crescent is moments away from West Kensington and Barons Court stations, as well as the local shops and the A4 for easy access into and out of central London.

Features

- New Lease
- Two Bedrooms
- First Floor
- No Chain
- Great Location
- Modern

Beaumont Crescent, London, W14

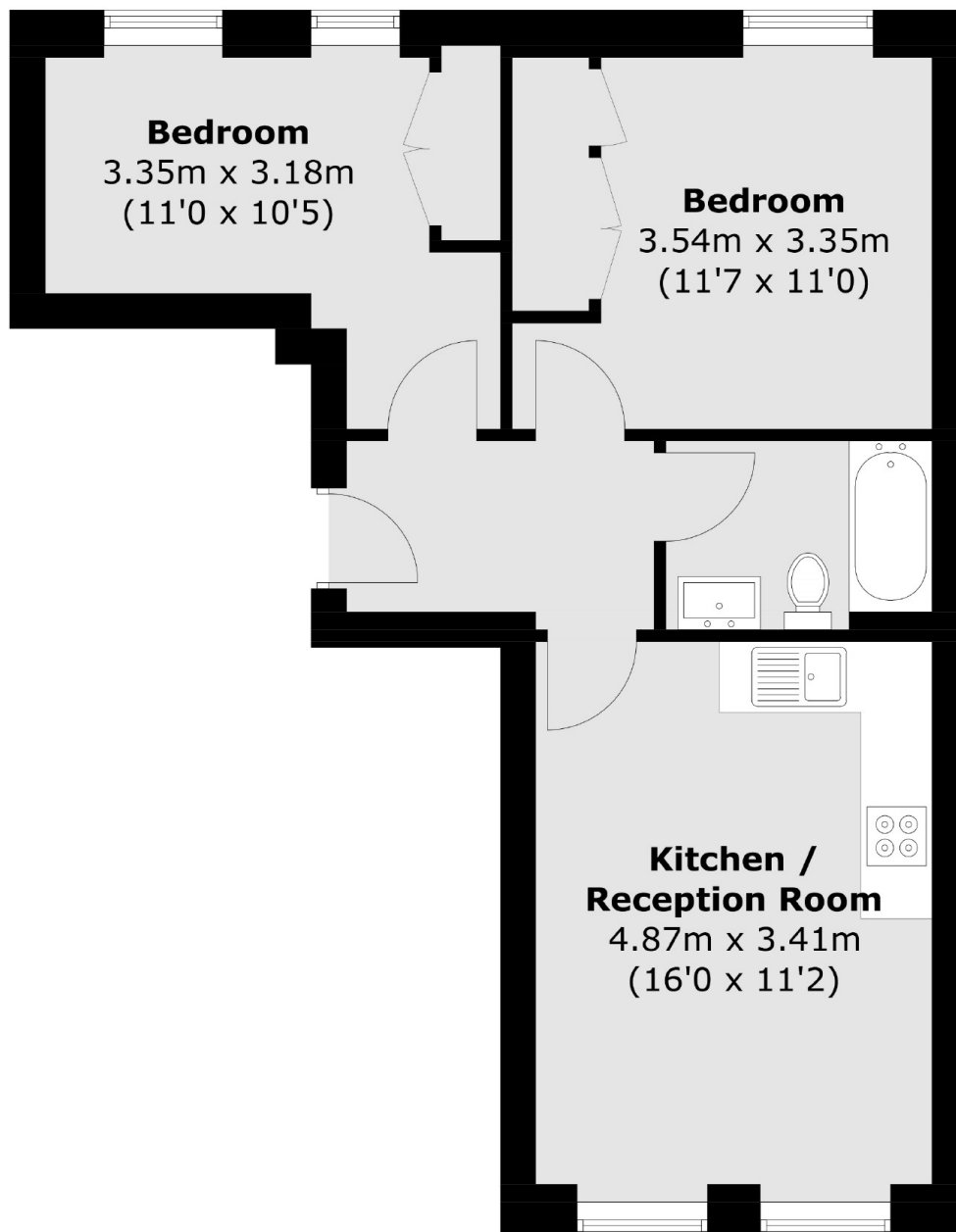

First Floor

Total area (approx.): 46.1 sq. m (496.2 sq. ft)