



Manor Lane, TW16

£1,195,000

A beautiful five bedroom house with off-street parking, a garage and a large south facing garden. This spacious family home offers flexible layout and is perfect for an upsizing family.

Located on Manor Lane between The Avenue and Green Street in the heart of Lower Sunbury, everything the village has to offer is close by including Cedars Recreation Ground, Sunbury Park, the River Thames and Sunbury station.

Features

- Detached
- Five Bedrooms
- Three Reception Rooms
- Two Bathrooms
- Utility Room
- Garage



Manor Lane, TW16

The ground floor has an amazing flow with an entrance hallway, a generous kitchen breakfast room with a separate utility room, a WC, a dining room with a feature fireplace, a snug that leads out on to the rear garden and a generous dual aspect main reception room.

On the first floor there is a master bedroom with built-in wardrobes and an en suite bathroom with a bath and separate shower. There are three further double bedrooms, a family bathroom and a fifth bedroom that could be used as a nursery or a study.

To the rear of the property is a lovely 75' mature private garden with two raised decked areas. To the front of the property there is ample off-street parking and access to the garage.



Manor Lane, Sunbury-On-Thames, TW16



First Floor

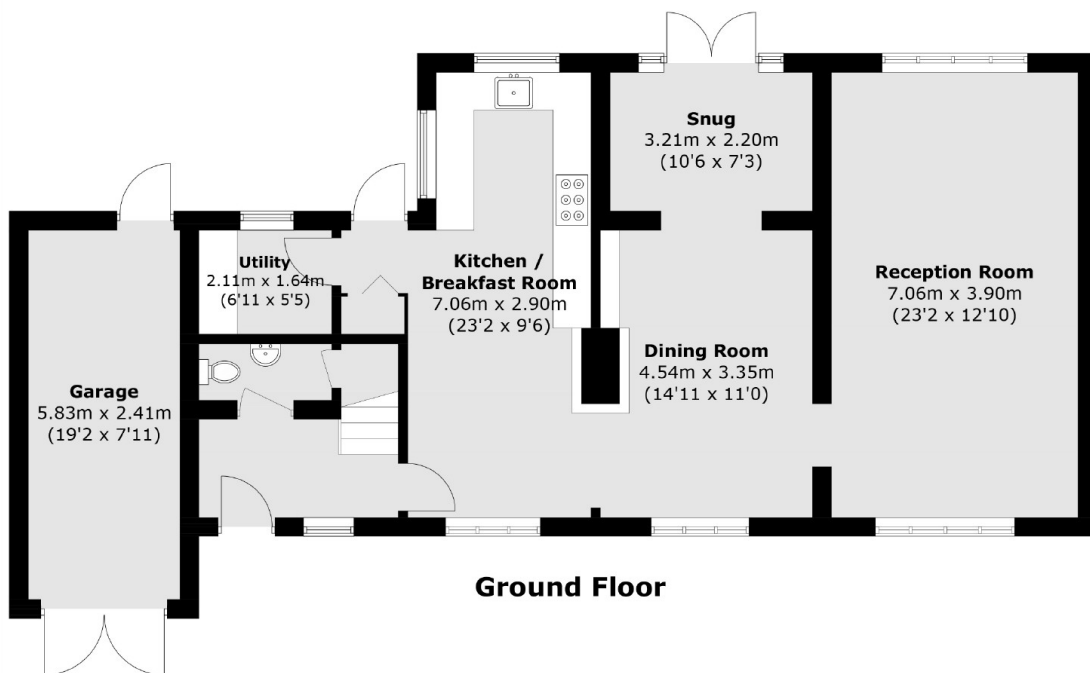

Ground Floor

Total area (approx.): 172.1 sq. m (1,852.4 sq. ft)
Garage area : 14.5 sq. m (156.0 sq. ft)