



Wright Gardens, TW17

£495,000

A modern two bedroom, two bathroom house with off-street parking, a garage and a private garden. This smartly presented home has the added bonuses of a recently fitted kitchen, a downstairs W.C. And a low maintenance rear garden.

Wright Gardens is a quiet residential cul-de-sac located off Laleham Road. Shepperton Station, which provides a direct service into London Waterloo, and the busy High Street are approximately half a mile away.

Features

- Freehold House
- Two Bedrooms
- Two Bathrooms
- Modern Kitchen
- Off-Street Parking
- Garage

Wright Gardens, Shepperton, TW17

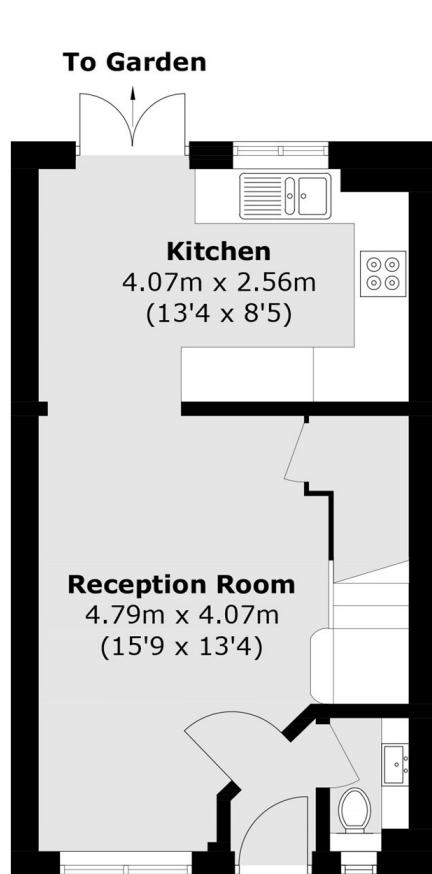

Ground Floor

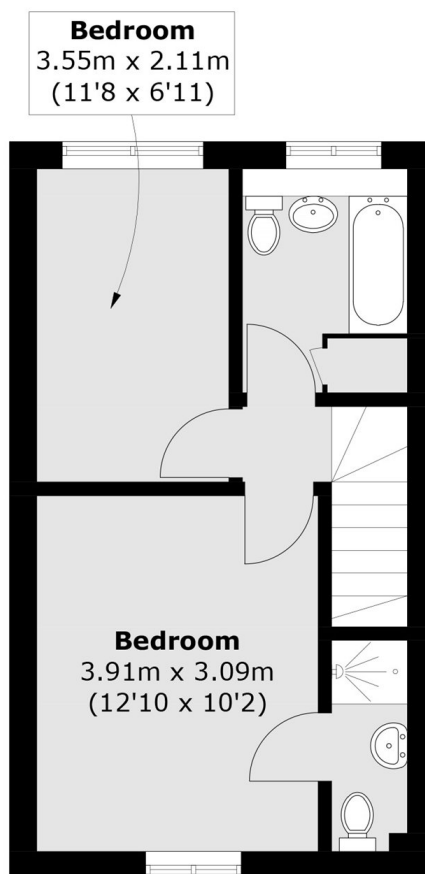

First Floor

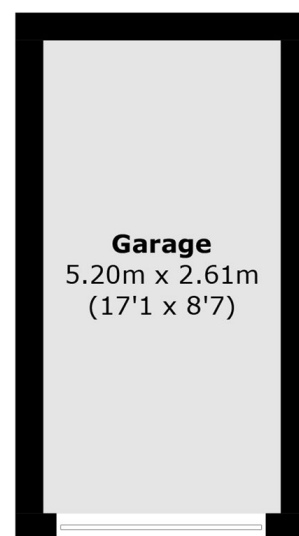

**(Not Shown In Actual
Location / Orientation)**

Total area (approx.): 61.3 sq. m (659.7 sq. ft)
Garage: 13.6 sq. m (146.3 sq. ft)