



Benwell Court, TW16

£235,000

A smartly presented one bedroom ground floor maisonette with allocated parking. The property has recently been fully refurbished to a high standard included a new kitchen and a new bathroom and is being sold with the added bonus of no forward chain.

Benwell Court is a gated development located close to Sunbury Station. The property provides easy access to everything Sunbury has to offer including the local shops, parks and the River Thames.

Features

Ground Floor
One Bedroom
Recently Refurbished
Allocated Parking
No Forward Chain
Gated Development

Benwell Court, Sunbury-On-Thames, TW16

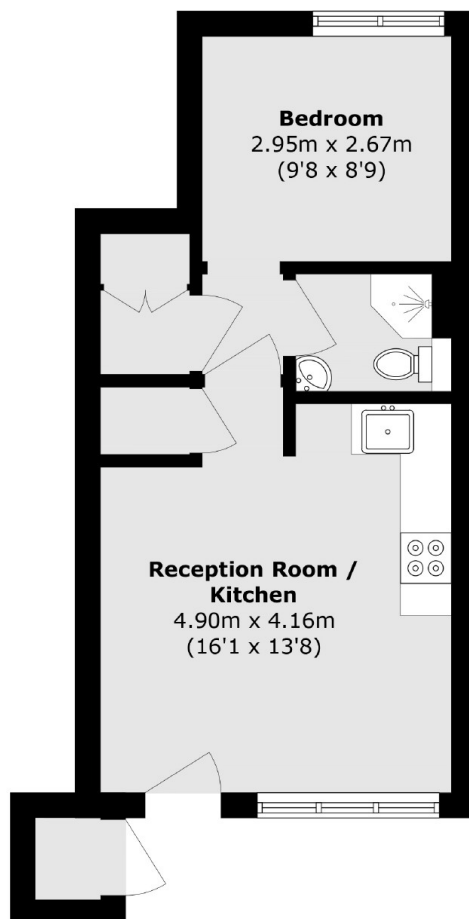

Total area (approx.): 34.4 sq. m (370.2 sq. ft)

External Shed area (approx.): 7.4 sq. m (79.6 sq. ft)