



Bowater Gardens, TW16

£699,950

A beautifully presented four bedroom three bathroom townhouse that has recently been remodelled and refurbished. With off-street parking, a fantastic open plan kitchen and a south facing garden this property is not to be missed out on.

Bowater Gardens is a modern development off French Street. The local shops, the River Thames, Sunbury Park and Kempton Park Station which provides a direct service into London Waterloo are all close by.

Features

- Townhouse
- Four Bedrooms
- Three Bathrooms
- Off-Street Parking
- South Facing Garden
- Two Reception Rooms



Bowater Gardens, TW16

On the ground floor there is spacious reception room with bi folding doors leading onto the garden, this floor has been completely remodelled to create a large dual aspect open plan kitchen, dining and living space which is flooded with natural light. There is the added bonus of built in storage and a downstairs W.C.

On the first floor there is a generous second reception room with a Juliette balcony, a bedroom with en suite shower room and an additional separate W.C.

The second floor has a family bathroom, three further bedrooms, one of which has an en suite shower room and walk in wardrobe.



Bowater Gardens, Sunbury-On-Thames, TW16

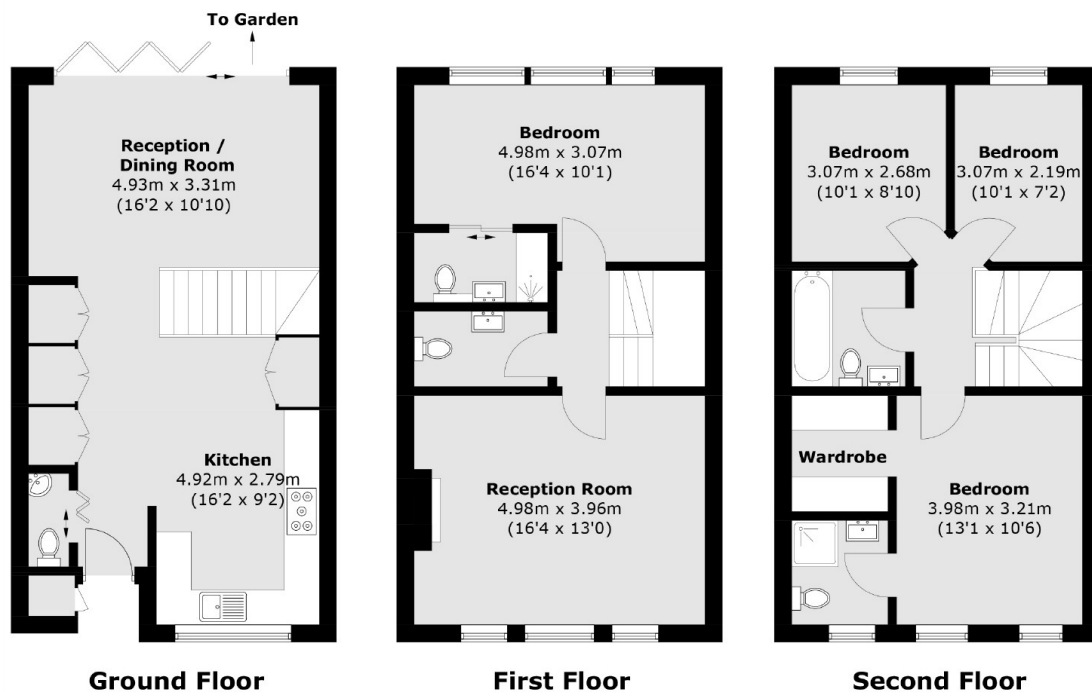

Total area (approx.): 138.7 sq. m (1,492.9 sq. ft)