



The Vale, TW16

£490,000

A two bedroom end of terrace house with a conservatory, off street parking and a large rear garden. The property has potential to be extended subject to planning permission.

The Vale is a great location, this quiet cul de sac is located off Ashridge Way. Sunbury station and the shops at Sunbury Cross are just over half a mile away.

Features

- End Of Terrace
- Two Bedrooms
- Conservatory
- Off Street Parking
- Large Rear Garden
- Potential to Extend (STPP)

The Vale, Sunbury-On-Thames, TW16

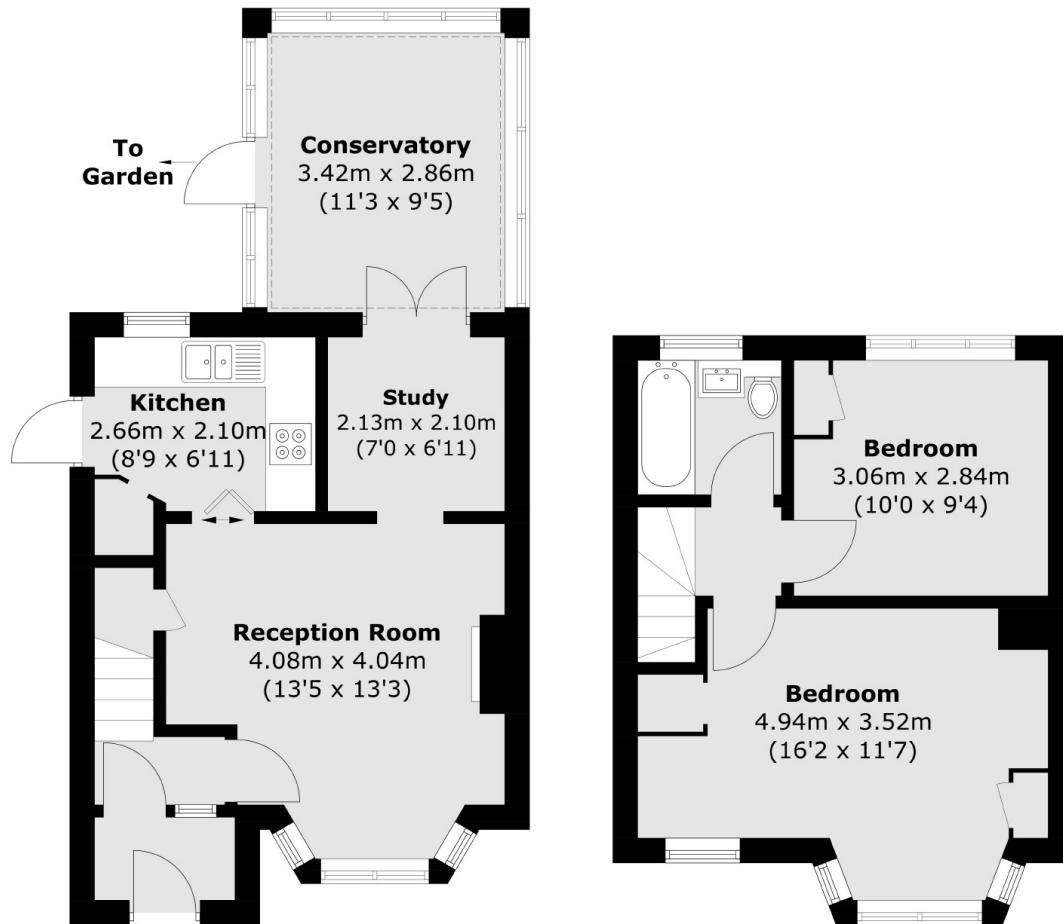

Ground Floor

First Floor

Total area (approx.): 71.7 sq. m (771.7 sq. ft)