



Thames Street, TW16

£250,000

A two bedroom top floor apartment with a light and spacious living room, two bedrooms and a bathroom. The property would be ideal for a first time buyer or someone looking to downsize and there is the added bonus of no forward chain.

Thames Street is positioned in the heart Lower Sunbury Village, close to The River Thames and Rivermead Island. The local shops and riverside pubs are all close by.

Features

- No Forward Chain
- Two Bedrooms
- Top Floor
- Character Property
- Central Village Location

Thames Street, Sunbury-On-Thames, TW16

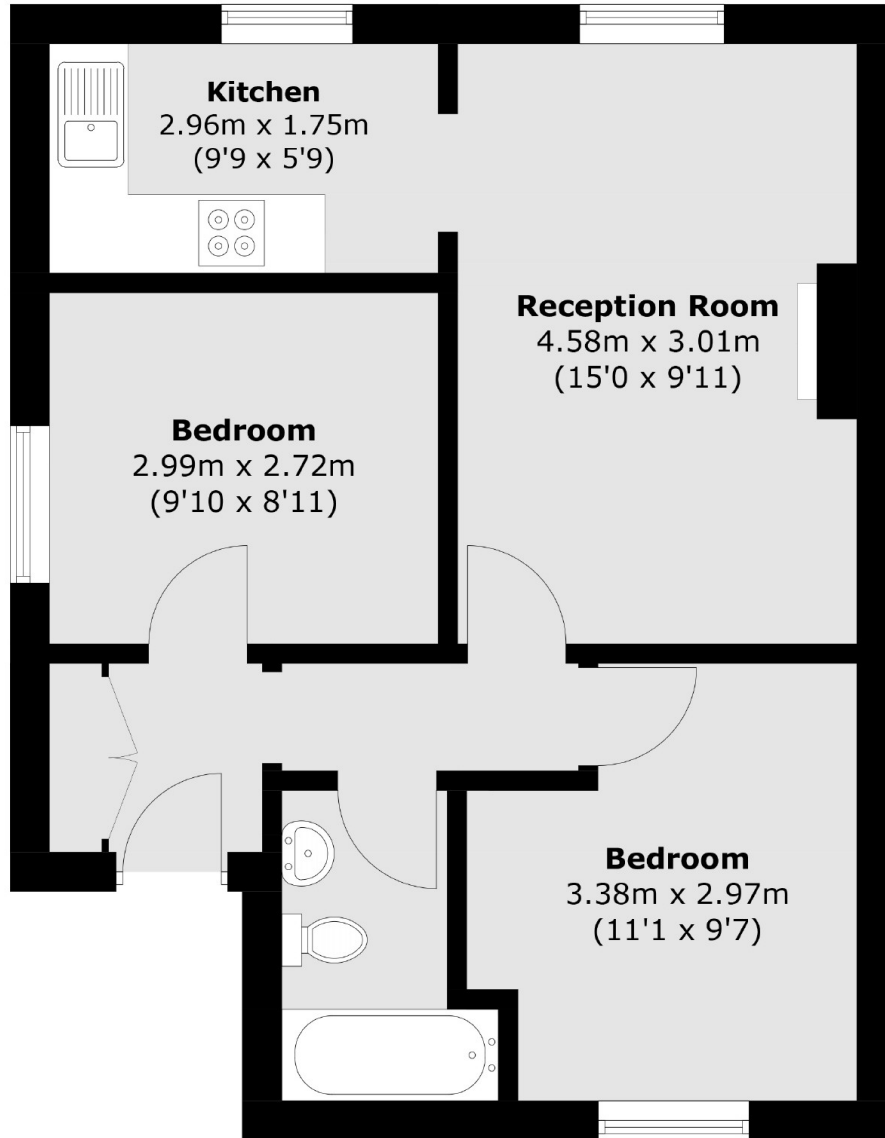

Total area (approx.): 46.4 sq. m (499.4 sq. ft)