



Kingsmead Avenue, TW16

£750,000

An extended three bedroom detached house with off street parking, a garage and a beautiful rear garden. This lovely property is filled with potential and will make a perfect family home.

What a location! Kingsmead Avenue is a quiet residential road in the heart of Sunbury Village, everything Lower Sunbury has to offer is close by including the local shops, the River Thames, riverside pubs and Sunbury Park.

Features

- Detached
- Three Bedrooms
- Two Reception Rooms
- Conservatory
- Landscaped Rear Garden
- Garage

Kingsmead Avenue, Sunbury-On-Thames, TW16

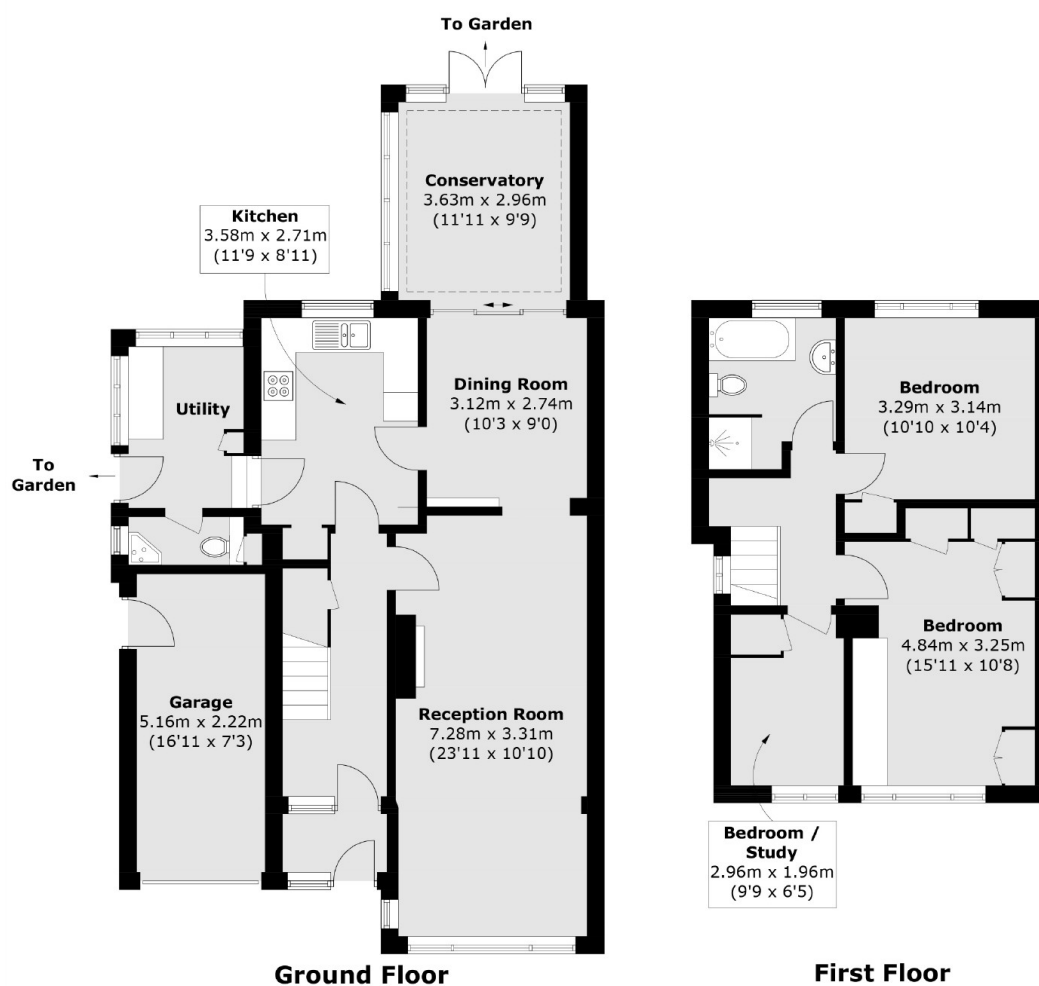

Total area (approx.): 119.6 sq. m (1,287.3 sq. ft)
Garage (approx.): 11.9 sq. m (128.1 sq. ft)