



Vereker Drive, TW16

£780,000

An extended and spacious three bedroom detached house with off-street parking and a garage. This lovely family home would be ideal for a family that are looking for a house that they can put their own stamp on and has the added bonus of no forward chain.

Located in the heart of Lower Sunbury, within the highly sought after Berg development, Vereker Drive is the perfect location! Everything Sunbury Village has to offer is close by including Sunbury Park and the famous 'Walled Garden' the local village shops, the River Thames and riverside pubs.

Features

- No Forward Chain
- Detached
- Three Bedrooms
- Two Reception Rooms
- Private Garden
- Garage



Vereker Drive, TW16

On the ground floor there is a welcoming entrance hallway with a cloakroom, kitchen, dining room and an extended reception room with a feature fire place, parquet flooring and patio doors opening on to the garden.

On the first floor there is a main bedroom with built in wardrobes and a vanity unit, two further double bedrooms and a family bathroom.

This incredible house has been in the same family since new when they brought it in the 1950's. It is filled with potential and scope for further extension (STPP) an early viewing is highly recommended to avoid missing out.



Vereker Drive, Sunbury-On-Thames, TW16

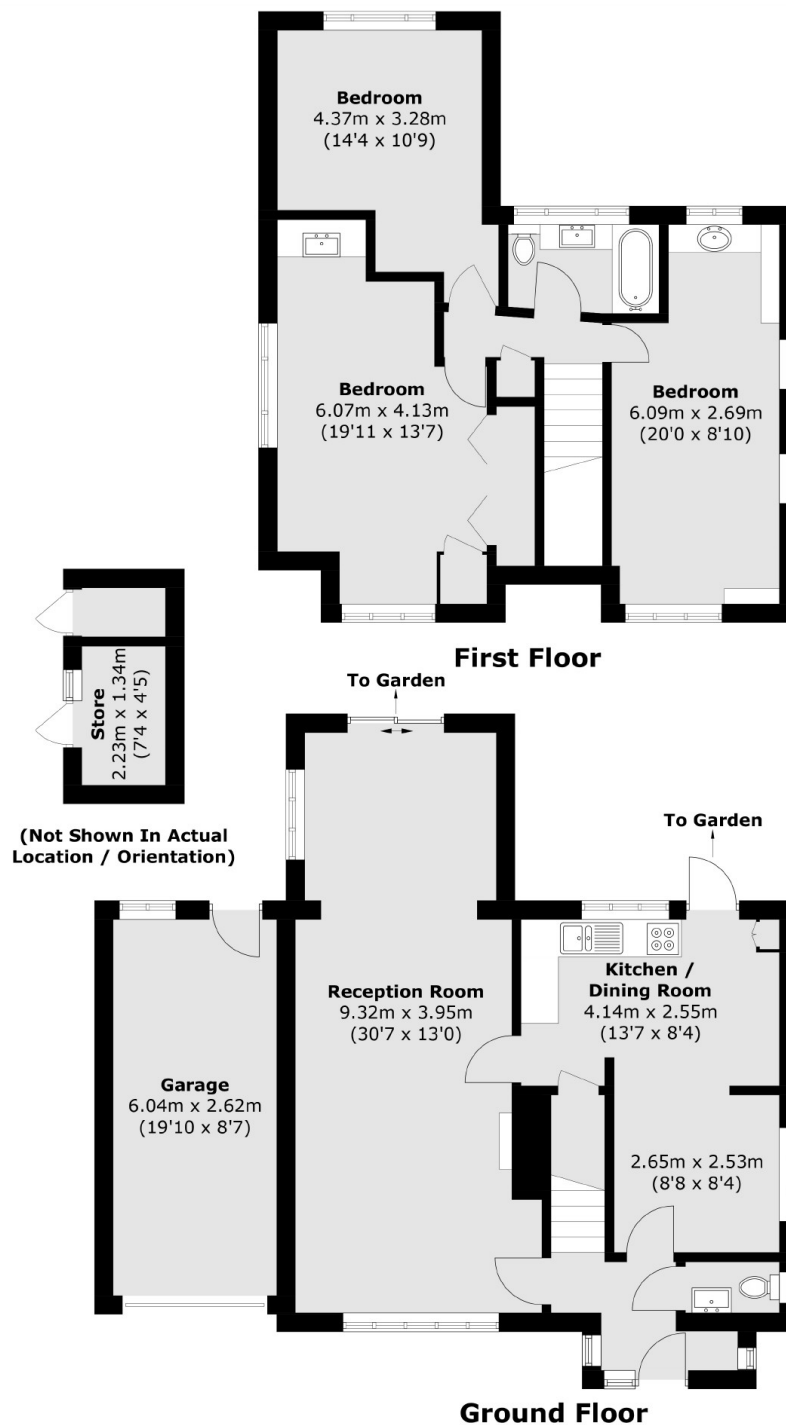

Total area (approx.): 117.8 sq. m (1,268.0 sq. ft)
Garage & Store (approx.): 20.4 sq. m (219.6 sq. ft)

Dexters

Sunbury
22 Thames Street
Sunbury-On-Thames
TW16 6AF
Sales
01932 781100

Energy Rating: E. We aim to make our particulars both accurate and reliable. However they are not guaranteed; nor do they form part of an offer or contract. If you require clarification on any points then please contact us, especially if you're traveling some distance to view. Please note that appliances and heating systems have not been tested and therefore no warranties can be given as to their good working order.

 **RICS** | Regulated
Estate Agent
and Letting Agent

[dexters.co.uk](https://www.dexters.co.uk)