



## Lendy Place, TW16

£495,000

A second floor, three bedroom, two bathroom modern apartment within an exclusive gated development. The property is being sold with no forward chain and you will only need to unpack to start enjoying your new home.

Lendy Place is a perfect location - across the road from the River Thames. With Riverside pubs, Sunbury Park and the Walled Garden right on your doorstep.

### Features

- Three Bedroom
- Two Bathroom
- Allocated Parking
- Second Floor
- Gated Development
- Communal Gardens

# Lendy Place, Sunbury-On-Thames, TW16

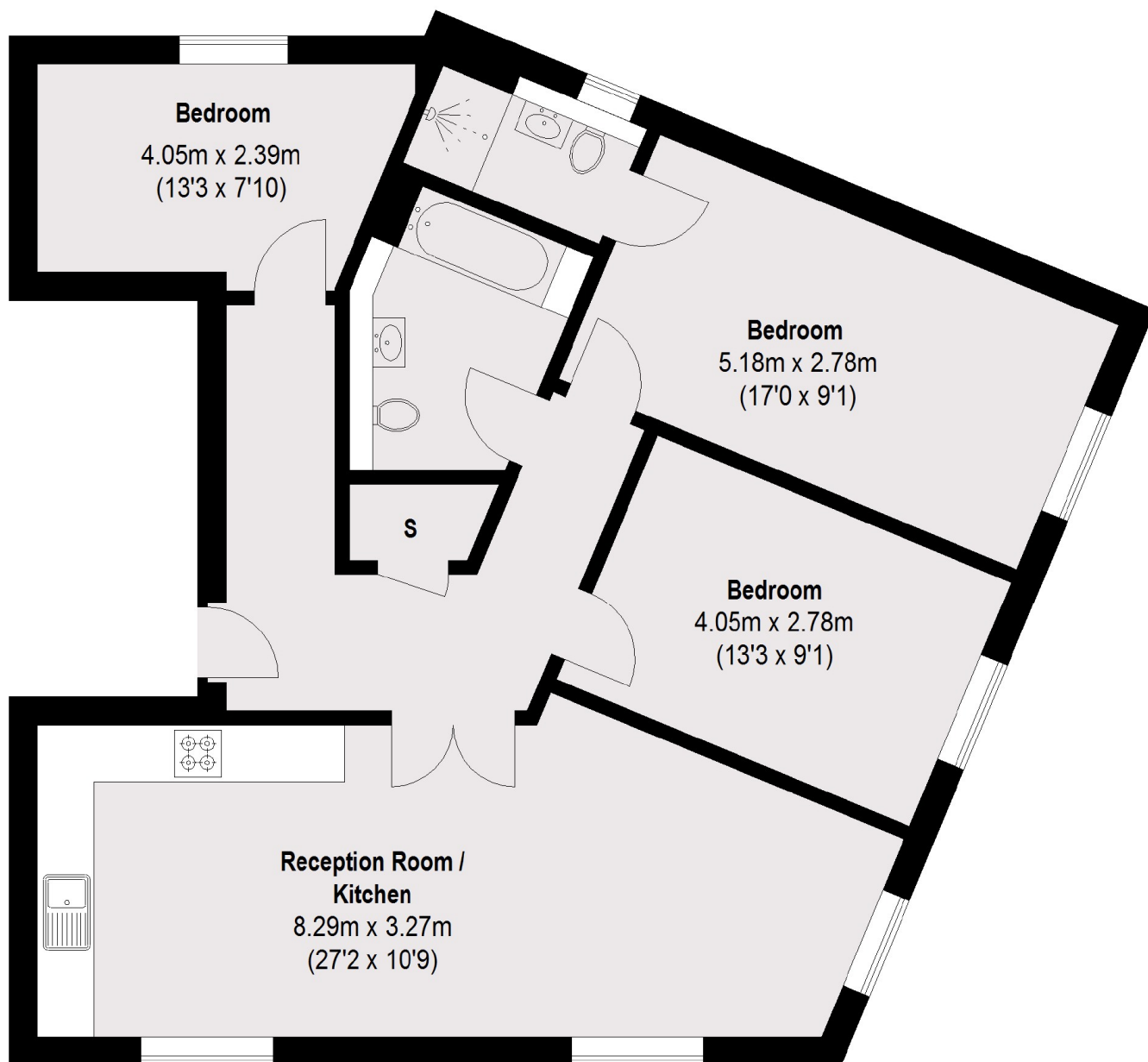

Total area (approx.): 87.42 sq. m (941 Sq. ft)

**Dexters**

Sunbury  
22 Thames Street  
Sunbury-On-Thames  
TW16 6AF

Sales  
01932 781100

Energy Rating: B. We aim to make our particulars both accurate and reliable. However they are not guaranteed; nor do they form part of an offer or contract. If you require clarification on any points then please contact us, especially if you're traveling some distance to view. Please note that appliances and heating systems have not been tested and therefore no warranties can be given as to their good working order.

 **RICS** | Regulated  
Estate Agent  
and Letting Agent

dexters.co.uk